

COPPERTUBE CRIMPING LUGS - HR SERIES for copper conductors



Description:

- HR series cable lugs are manufactured from electrolytic copper tube Cu-OF CW008A conform to UNI EN 13600:2003 with enough section to guarantee both, good electrical connection and traction resistance.
- Annealed and electrolytically tin plated with a minimum thickness of 3µm to avoid oxidation.
- The annealing process optimizes the structural features of the material, allows an easier crimping and guarantees the use of the connector even with mechanical solicitations of various nature.
- The barrel entrance is chamfered for an easy and correct introduction of the conductor; its length is so made to facilitate the precise positioning inside the dies of the tools.

Each connector is marked as follows:

- trade mark and Cembre catalogue number.
- section of the conductor (mm²).
- Ø of the screw (mm).

Cembre SpA

Via Serenissima, 9 - 25135 Brescia (Italy)

Tel.: +39 030 36921 - Fax: +39 030 3365766

Web: www.cembre.com - Email: info@cembre.com

COPPERTUBE CRIMPING LUGS - HR SERIES

for copper conductors

Sections and Dimensions:

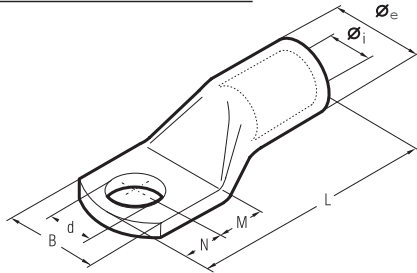

Cond. Size sqmm	Ø Stud mm	Ref.	Dimensions mm						
			Øi	Øe	B	M	N	L	d
10	6	HR10-6	4,5	7,0	12,0	7,5	7,5	30,5	6,4
	8	HR10-8	4,5	7,0	15,0	10,0	10,0	35,5	8,4
	10	HR10-10	4,5	7,0	18,0	12,0	12,0	39,5	10,5
	12	HR10-12	4,5	7,0	19,0	13,0	13,0	41,5	13,2
16	6	HR16-6	5,5	8,5	12,0	7,5	7,5	33,0	6,4
	8	HR16-8	5,5	8,5	15,0	10,0	10,0	38,0	8,4
	10	HR16-10	5,5	8,5	18,0	12,0	12,0	42,0	10,5
	12	HR16-12	5,5	8,5	20,0	13,0	13,0	44,0	13,2
25	6	HR25-6	7,0	10,0	14,0	7,5	7,5	35,0	6,4
	8	HR25-8	7,0	10,0	15,0	10,0	10,0	40,0	8,4
	10	HR25-10	7,0	10,0	18,0	12,0	12,0	44,0	10,5
	12	HR25-12	7,0	10,0	20,0	13,0	13,0	46,0	13,2
	14	HR25-14	7,0	10,0	21,0	14,0	14,0	48,0	15,0
35	6	HR35-6	8,5	12,0	17,0	7,5	7,5	38,5	6,4
	8	HR35-8	8,5	12,0	17,0	10,0	10,0	43,5	8,4
	10	HR35-10	8,5	12,0	18,0	12,0	12,0	47,5	10,5
	12	HR35-12	8,5	12,0	21,0	13,0	13,0	49,5	13,2
	14	HR35-14	8,5	12,0	21,0	14,0	14,0	51,5	15,0
50	6	HR50-6	10,0	14,0	20,0	10,0	10,0	47,5	6,4
	8	HR50-8	10,0	14,0	20,0	10,0	10,0	47,5	8,4
	10	HR50-10	10,0	14,0	20,0	12,0	12,0	51,5	10,5
	12	HR50-12	10,0	14,0	21,0	13,0	13,0	53,5	13,2
	14	HR50-14	10,0	14,0	21,0	14,0	14,0	55,5	15,0
70	6	HR70-6	12,0	16,5	24,0	10,0	10,0	53,0	6,4
	8	HR70-8	12,0	16,5	24,0	10,0	10,0	53,0	8,4
	10	HR70-10	12,0	16,5	24,0	12,0	12,0	57,0	10,5
	12	HR70-12	12,0	16,5	24,0	13,0	13,0	59,0	13,2
	14	HR70-14	12,0	16,5	24,0	14,0	14,0	61,0	15,0
95	6	HR95-6	12,0	16,5	30,0	18,0	16,0	67,0	17,0
	8	HR95-8	13,5	18,0	26,0	10,0	10,0	57,0	8,4
	10	HR95-10	13,5	18,0	26,0	12,0	12,0	61,0	10,5
	12	HR95-12	13,5	18,0	26,0	13,0	13,0	63,0	13,2
	14	HR95-14	13,5	18,0	26,0	14,0	14,0	65,0	15,0
120	6	HR95-16	13,5	18,0	30,0	18,0	16,0	71,0	17,0
	20	HR95-20	13,5	18,0	36,0	22,0	21,0	80,0	21,0
	8	HR120-8	15,0	19,5	29,0	14,0	14,0	67,5	8,4
	10	HR120-10	15,0	19,5	29,0	14,0	14,0	67,5	10,5
	12	HR120-12	15,0	19,5	29,0	14,0	14,0	67,5	13,2
150	14	HR120-14	15,0	19,5	29,0	15,0	15,0	69,5	15,0
	16	HR120-16	15,0	19,5	31,0	18,0	16,0	73,5	17,0
	20	HR120-20	15,0	19,5	36,0	22,0	21,0	82,5	21,0
	8	HR150-8	16,5	21,0	31,0	14,0	14,0	72,5	8,4
	10	HR150-10	16,5	21,0	31,0	14,0	14,0	72,5	10,5
185	12	HR150-12	16,5	21,0	31,0	14,0	14,0	72,5	13,2
	14	HR150-14	16,5	21,0	31,0	15,0	15,0	74,5	15,0
	16	HR150-16	16,5	21,0	31,0	18,0	16,0	78,5	17,0
	20	HR150-20	16,5	21,0	36,0	22,0	21,0	87,5	21,0
	10	HR185-10	19,0	24,0	35,0	18,0	16,0	84,5	10,5
240	12	HR185-12	19,0	24,0	35,0	18,0	16,0	84,5	13,2
	14	HR185-14	19,0	24,0	35,0	18,0	16,0	84,5	15,0
	16	HR185-16	19,0	24,0	35,0	18,0	16,0	84,5	17,0
300	20	HR185-20	19,0	24,0	37,0	22,0	21,0	93,5	21,0
	10	HR240-10	21,0	26,0	39,0	18,0	16,0	90,5	10,5
	12	HR240-12	21,0	26,0	39,0	18,0	16,0	90,5	13,5
	14	HR240-14	21,0	26,0	39,0	18,0	16,0	90,5	15,0
300	16	HR240-16	21,0	26,0	39,0	22,0	21,0	99,5	17,0
	20	HR240-20	21,0	26,0	39,0	22,0	21,0	99,5	21,0
	12	HR300-12	23,5	29,5	44,0	18,0	16,0	99,5	13,5
	16	HR300-16	23,5	29,5	44,0	22,0	21,0	108,5	17

Cembre SpA

Via Serenissima, 9 - 25135 Brescia (Italy)

Tel.: +39 030 36921 - Fax: +39 030 3365766

Web: www.cembre.com - Email: info@cembre.com

COPPERTUBE CRIMPING LUGS - HR SERIES
for copper conductors

Die Selector Chart:

APPLICATION	Conductor Size sqmm	TERMINAL		B 15WID	B 35-45WID	B 35-50WID	HT 45	HT 51 RHIM 50 B 500	HT 81-JUD RHU 81/D HT 61 RH 61 B 600*	HT 120 and tools and heads with 130 kN crimping force		ECW-HSD	
		LUGS	SPLICES							DIE SET	DIE SET		DIE
DM.	6-10	DR10..	DSV6	MK5	MK550	MK550	MK5	MK550	MK550	MK550	MK550	MOM100C	Adapter AU 230130 D with die set MK..C
	10-16	DR16..	DSV10	MK6	MK650	MK650	MK6	MK650	MK650	MK650	MK650	MOM16C	
	16-25	DR25..	DSV16	MK8	MK850	MK850	MK8	MK850	MK850	MK850	MK850	MOM16C	
	25-35	DR35..	DSV25	MK10	MK1050	MK1050	MK10	MK1050	MK1050	MK1050	MK1050	MOM25C	
	35-50	DR50..	DSV25	MK12	MK1250	MK1250	MK12	MK1250	MK1250	MK1250	MK1250	MOM35C	
	50-70	DR70..	DSV50	MK14	MK1450	MK1450	MK14	MK1450	MK1450	MK1450	MK1450	MOM50C	
	70-95	DR95..	DSV70	MK16	MK1650	MK1650	MK16	MK1650	MK1650	MK1650	MK1650	MOM70C	
	95-120	DR120..	DSV70	MK18	MK1850	MK1850	MK18	MK1850	MK1850	MK1850	MK1850	MOM95C	
	120-150	DR150..	DSV120	MK20	MK2050	MK2050	MK20	MK2050	MK2050	MK2050	MK2050	MOM120C	
	150-185	DR185..	DSV150	MK22L	MK22L50	MK22L50	MK22L	MK2250	MK2250	MK2250	MK2250	MOM150C	
DR.	6	DR6..	DSV6	MK5	MK550	MK550	MK5	MK550	MK550	MK550	MK550	MOM100C	Adapter AU 230130 D with die set MK..C
	10	DR10..	DSV10	MK6	MK650	MK650	MK6	MK650	MK650	MK650	MK650	MOM16C	
	16	DR16..	DSV16	MK8	MK850	MK850	MK8	MK850	MK850	MK850	MK850	MOM16C	
	25	DR25..	DSV25	MK10	MK1050	MK1050	MK10	MK1050	MK1050	MK1050	MK1050	MOM25C	
	35	DR35..	DSV25	MK12	MK1250	MK1250	MK12	MK1250	MK1250	MK1250	MK1250	MOM35C	
	50	DR50..	DSV50	MK14	MK1450	MK1450	MK14	MK1450	MK1450	MK1450	MK1450	MOM50C	
	70	DR70..	DSV70	MK16	MK1650	MK1650	MK16	MK1650	MK1650	MK1650	MK1650	MOM70C	
	95	DR95..	DSV70	MK18	MK1850	MK1850	MK18	MK1850	MK1850	MK1850	MK1850	MOM95C	
	120	DR120..	DSV120	MK20	MK2050	MK2050	MK20	MK2050	MK2050	MK2050	MK2050	MOM120C	
	150	DR150..	DSV150	MK22L	MK22L50	MK22L50	MK22L	MK2250	MK2250	MK2250	MK2250	MOM150C	
DS.	185	DR185..	DSV185					MK2550	MK2550	MK2550	MK2550	MOM25C	Adapter AU 230130 D with die set MH..C
	240	DR240..	DSV240					MK2850	MK2850	MK2850	MK2850	MOM28C	
	300	DR300..	DSV300									MOM32C	
	400	DR400..	DSV400									MOM38-30	
	500	DR500..	DSV500									MOM42-30	
	625	DR625..	DSV625									MOM44-30	
	10	HR10..	HSV10	MH10	MH1050	MH1050	MH10	MH1050	MH1050	MH1050	MH1050	MH10C	
	16	HR16..	HSV16	MH16	MH1650	MH1650	MH16	MH1650	MH1650	MH1650	MH1650	MH16C	
	25	HR25..	HSV25	MH25	MH2550	MH2550	MH25	MH2550	MH2550	MH2550	MH2550	MH25C	
	35	HR35..	HSV35	MH35	MH3550	MH3550	MH35	MH3550	MH3550	MH3550	MH3550	MH35C	
50	HR50..	HSV50	MH50	MH5050	MH5050	MH50	MH5050	MH5050	MH5050	MH5050	MH50C		
70	HR70..	HSV70	MH70	MH7050	MH7050	MH70	MH7050	MH7050	MH7050	MH7050	MH70C		
95	HR95..	HSV95	MH95	MH9550	MH9550	MH95	MH9550	MH9550	MH9550	MH9550	MH95C		
120	HR120..	HSV120	MH120	MH12050	MH12050	MH120	MH12050	MH12050	MH12050	MH12050	MH120C		
150	HR150..	HSV150	MH150L	MH150L50	MH150L50	MH150	MH15050	MH15050	MH15050	MH15050	MH150C		
185	HR185..	HSV185					MH18550	MH18550	MH18550	MH18550	MH185C		
240	HR240..	HSV240					MH24050	MH24050	MH24050	MH24050	MH240C		
300	HR300..	HSV300					MH30050**	MH30050**	MH30050**	MH30050**	MH300C		
400											MH400C		
500											MH500-30		
630											MH600-30		

*With tools type HT 61-JUD, RHU 81/D, HT 61, RH 61 and B 600 use the same die set of HT 51, using the spring with code 6522051
** Only for B 500 ; RH 50 ; B600 ; RH61.