

TEMPERATURE MONITORING RELAY PT100/1000
 KTY83/84, NTC 2 THRESH. VAL., DIGITAL -50 C - 500
 C, 24V AC/DC 2 X 1 W + 1 NO, WIDTH 45 MM CAGE-
 CLAMP - CONNECTION



Figure similar

General technical data:





| | | |
|--|----|-------|
| Type of voltage | | AC/DC |
| Supply voltage frequency 1 for auxiliary and control current circuit | | |
| • Initial rated value | Hz | 50 |
| • Final rated value | Hz | 60 |
| Control supply voltage 1 at AC | | |
| • at 50 Hz rated value | V | 24 |
| • at 60 Hz | | |
| — rated value | V | 24 |
| Control supply voltage 1 at DC | | |
| • rated value | V | 24 |
| Number of measuring circuits | | 1 |
| Product function | | |
| • Fault storage | | Yes |
| • External reset | | Yes |
| Measurable temperature | | |
| • initial value | °C | -50 |
| • Full-scale value | °C | 500 |

| | | |
|---|----|-------------|
| Equipment marking acc. to DIN EN 61346-2 | | K |
| Equipment marking acc. to DIN 40719 extended according to IEC 204-2 acc. to IEC 750 | | K |
| Ambient temperature during operation | °C | -25 ... +60 |

Mechanical data:

| | | |
|---|----|--|
| Type of electrical connection | | spring-loaded terminals |
| <ul style="list-style-type: none"> • for auxiliary and control current circuit • Plug-in socket | | Yes |
| Design of the sensor connectable | | PT100/1000, KTY83/84, NTC (resistance sensors) |
| Number of NC contacts for auxiliary contacts | | 0 |
| Number of NO contacts for auxiliary contacts | | 1 |
| Number of CO contacts for auxiliary contacts | | 2 |
| Width | mm | 45 |
| Height | mm | 108 |
| Depth | mm | 91 |

Certificates/ approvals:

| General Product Approval | Declaration of Conformity | Test Certificates | other |
|---|--|--|--|
|  CCC |  |  UL |  EG-Konf. |
| | | spezielle Prüfbescheinigung n | Umweltbestätigung |

other

[Bestätigungen](#)

Further information

Information- and Downloadcenter (Catalogs, Brochures,...)

<http://www.siemens.com/industrial-controls/catalogs>

Industry Mall (Online ordering system)

<http://www.siemens.com/industrymall>

Cax online generator

<http://support.automation.siemens.com/WW/CAXorder/default.aspx?lang=en&mlfb=3RS10402GD50>

Service&Support (Manuals, Certificates, Characteristics, FAQs,...)

<https://support.industry.siemens.com/cs/ww/en/ps/3RS10402GD50>

Image database (product images, 2D dimension drawings, 3D models, device circuit diagrams, EPLAN macros, ...)

http://www.automation.siemens.com/bilddb/cax_de.aspx?mlfb=3RS10402GD50&lang=en

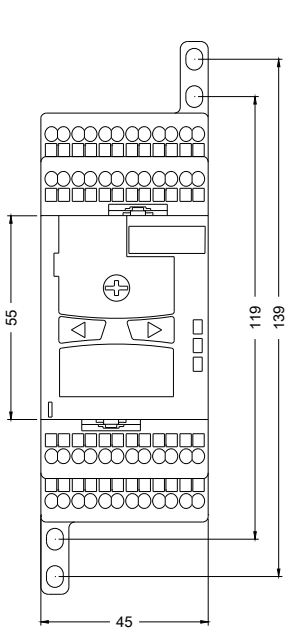

last modified:

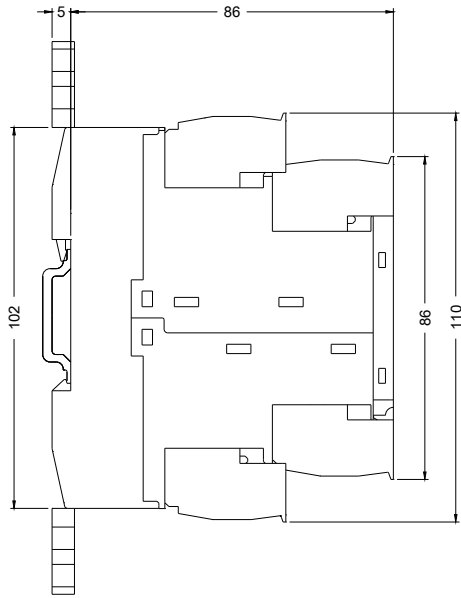

02.06.2016