



MAGNETICALLY OPERATED SWITCH, CONT. BLOCK, RECTANGULAR SMALL 26X36 MM, FOR DOOR HINGE LEFT, CONTACTS: SAFETY CONTACTS 2NC, SIGNALING CONTACT 1NC, WITH 8MM CATCH CONNECTION, CONNECTOR 6-POLE, WITHOUT LED, MATCHING SWITCHING MAGNET 3SE6714-3CA OR OFFSET BY 90 DEGREES 3SE6724-3CA

Figure similar

<b>Product designation</b>	magnetically operated switch, switch block
Suitability for use safety-related circuits	Yes

**General technical data:**

<b>Product function</b>	
<ul style="list-style-type: none"> <li>• positive opening</li> </ul>	No
<ul style="list-style-type: none"> <li>• cross-circuit/short-circuit recognition</li> </ul>	Yes
Type of voltage of the operating voltage	DC
<b>Protection class IP</b>	IP67
<b>Shock resistance</b>	
<ul style="list-style-type: none"> <li>• acc. to IEC 60068-2-27</li> </ul>	Sinusoidal half-wave 30g / 11 ms
<b>Vibration resistance</b>	
<ul style="list-style-type: none"> <li>• acc. to IEC 60068-2-6</li> </ul>	10 ... 55 Hz: 1 mm
<b>Equipment marking</b>	
<ul style="list-style-type: none"> <li>• acc. to DIN 40719 extended according to IEC 204-2 acc. to IEC 750</li> </ul>	S
<ul style="list-style-type: none"> <li>• acc. to DIN EN 61346-2</li> </ul>	S
<ul style="list-style-type: none"> <li>• acc. to DIN EN 81346-2</li> </ul>	S
<b>Type of voltage</b>	DC
<b>Height of the sensor</b>	36 mm

<b>Length of the sensor</b>	13 mm
<b>Width of the sensor</b>	26 mm
<b>Material of the active sensor area</b>	Plastic, glass-fiber reinforced thermoplastic
<b>Mechanical installation condition for sensor</b>	can be installed almost flush
Operating voltage rated value	30 V
<b>Operating current rated value</b>	400 mA
Operating power rated value	10 W
<b>Number of NC contacts</b>	
• for auxiliary contacts	3
• safety-related	2
<b>Number of NO contacts</b>	
• for auxiliary contacts	0
• safety-related	0

#### Enclosure:

<b>Material of the enclosure</b>	Plastic, glass-fiber reinforced thermoplastic
<b>Opening direction of the door</b>	left

#### Actuator:

<b>Design of the operating mechanism</b>	magnet
--	--------

#### Contact:

<b>Switching frequency</b>	5 Hz
<b>Safe operating distance OFF</b>	15 mm
<b>Safe operating distance ON</b>	5 mm
<b>Design of the switching function</b>	NC contact
Number of switching contacts for signaling function	1
• safety-related	0

#### Connections/ Terminals:

<b>Type of electrical connection</b>	Connector, diameter 8 mm latching connection, 6-pole
--------------------------------------	--

#### Safety related data:

<b>B10 value with high demand rate acc. to SN 31920</b>	12 500 000
<b>Safety Integrity Level (SIL) acc. to IEC 61508</b>	SIL3
<b>Performance level (PL) acc. to EN ISO 13849-1</b>	e
<b>Proportion of dangerous failures</b>	
• with low demand rate acc. to SN 31920	50 %
• with high demand rate acc. to SN 31920	50 %
<b>T1 value for proof test interval or service life acc. to IEC 61508</b>	20 y

#### Ambient conditions:

<b>Ambient temperature</b>	
• during operation	-25 ... +70 °C
• during storage and transport	-25 ... +70 °C

## Inputs/ Outputs:

<b>Number of outputs as contact-affected switching element</b>	
• as NC contact	
— for signaling function instantaneous contact	1
— safety-related instantaneous contact	2
• as NO contact	
— safety-related instantaneous contact	0
<b>Number of semiconductor outputs</b>	
• for signaling function	0
• safety-related	0

## Display:

<b>Evaluation version required</b>	yes
------------------------------------	-----

## Installation/ mounting/ dimensions:

<b>Mounting type</b>	screw fixing
----------------------	--------------

## Certificates/approvals

### General Product Approval



## Further information

### Information- and Downloadcenter (Catalogs, Brochures,...)

<http://www.siemens.com/industrial-controls/catalogs>

### Industry Mall (Online ordering system)

<https://mall.industry.siemens.com/mall/en/en/Catalog/product?mlfb=3SE66173CA01>

### Cax online generator

<http://support.automation.siemens.com/WW/CAXorder/default.aspx?lang=en&mlfb=3SE66173CA01>

### Service&Support (Manuals, Certificates, Characteristics, FAQs,...)

<https://support.industry.siemens.com/cs/ww/en/ps/3SE66173CA01>

### Image database (product images, 2D dimension drawings, 3D models, device circuit diagrams, EPLAN macros, ...)

[http://www.automation.siemens.com/bilddb/cax\\_de.aspx?mlfb=3SE66173CA01&lang=en](http://www.automation.siemens.com/bilddb/cax_de.aspx?mlfb=3SE66173CA01&lang=en)

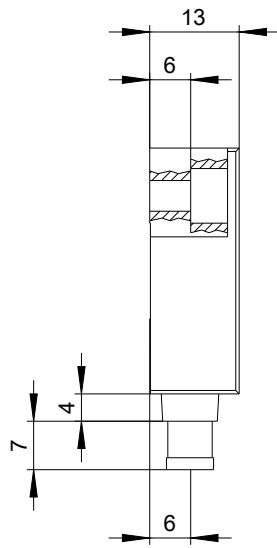
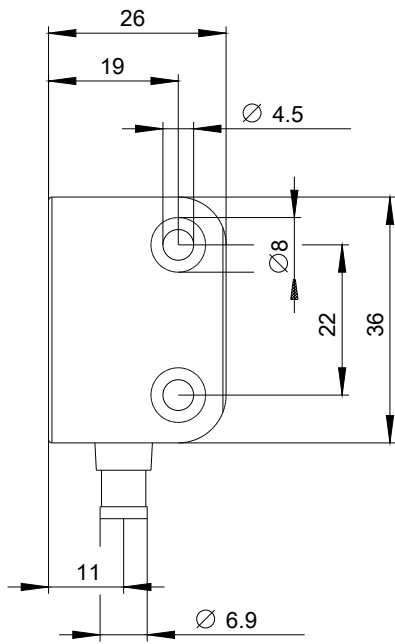

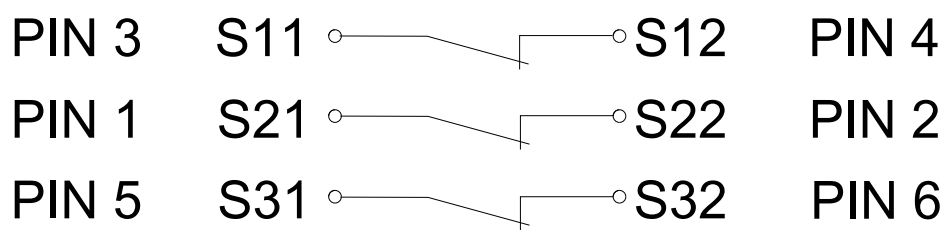

last modified:

07.12.2015