

ENCLOSURE FOR COMMAND DEVICES, 22MM, ROUND, ENCLOSURE MATERIAL PLASTIC, ENCLOSURE TOP PART GRAY, 1 COMMAND POINT PLASTIC, RECESS FOR LABEL, A=PUSHBUTTON BLACK LABEL: O 1NC, SCREW TERMINAL, BASE MOUNTING



Figure similar

<b>product brand name</b>	SIRIUS ACT
<b>Product designation</b>	Commanding and signaling devices
<b>Design of the product</b>	Enclosure
<b>Manufacturer article number</b>	<ul style="list-style-type: none"> <li>• of supplied contact module at the command point A 1 <a href="#">3SU1400-2AA10-1CA0</a></li> <li>• of the supplied holder at the command point A <a href="#">3SU1500-0AA10-0AA0</a></li> <li>• of the supplied actuator at the command point A <a href="#">3SU1000-0AB10-0AA0</a></li> <li>• of supplied empty enclosure <a href="#">3SU1801-0AA00-0AB1</a></li> <li>• of the supplied accessories at the command point A <a href="#">3SU1900-0AF16-0QA0</a></li> </ul>

Enclosure:	
<b>Design of the housing</b>	with recess for label
<b>Shape of the enclosure front</b>	Square
<b>Material of the enclosure</b>	plastic
<b>Number of command points</b>	1
<b>Product component</b>	No
<ul style="list-style-type: none"> <li>• EMERGENCY STOP device</li> </ul>	No

<ul style="list-style-type: none"> <li>• protective collar</li> </ul>	No
<b>Color</b>	
<ul style="list-style-type: none"> <li>• of top part of the enclosure</li> </ul>	grey
<b>Delivery state</b>	
<ul style="list-style-type: none"> <li>• as a kit</li> </ul>	No
<ul style="list-style-type: none"> <li>• pre-wired on strip terminal</li> </ul>	No
<b>Mounting type of the enclosure</b>	Vertical

#### Actuator:

<b>Design of the operating mechanism</b>	Pushbutton
<b>Product feature</b>	
<ul style="list-style-type: none"> <li>• lockout</li> </ul>	No
<b>Product expansion optional Light source</b>	No
<b>Color</b>	
<ul style="list-style-type: none"> <li>• of the actuating element</li> </ul>	black
<b>Material of the actuating element</b>	plastic
<b>Shape of the actuating element</b>	round
<b>Number of contact modules</b>	1

#### Front ring:

<b>Product component front ring</b>	Yes
<b>Design of the front ring</b>	Standard
<b>Material of the front ring</b>	plastic
<b>Color of the front ring</b>	black

#### Holder:

<b>Material of the holder</b>	Plastic
-------------------------------	---------

#### Display:

<b>Number of LED modules</b>	0
------------------------------	---

#### General technical data:

<b>Product function</b>	
<ul style="list-style-type: none"> <li>• positive opening</li> </ul>	Yes
<ul style="list-style-type: none"> <li>• EMERGENCY OFF function</li> </ul>	No
<ul style="list-style-type: none"> <li>• EMERGENCY STOP function</li> </ul>	No
<b>Protection class IP</b>	IP66, IP67, IP69(IP69K)
<b>Degree of protection NEMA rating</b>	NEMA 1, 2, 3, 3R, 4, 4X, 12
<b>Shock resistance</b>	
<ul style="list-style-type: none"> <li>• acc. to IEC 60068-2-27</li> </ul>	Sinusoidal half-wave 50 g / 11 ms
<ul style="list-style-type: none"> <li>• for railway applications acc. to DIN EN 61373</li> </ul>	Category 1, Class B
<b>Vibration resistance</b>	
<ul style="list-style-type: none"> <li>• acc. to IEC 60068-2-6</li> </ul>	10 ... 500 Hz: 5g
<ul style="list-style-type: none"> <li>• for railway applications acc. to DIN EN 61373</li> </ul>	Category 1, Class B
<b>Equipment marking</b>	

<ul style="list-style-type: none"> <li>• acc. to DIN EN 61346-2</li> </ul>	S
<ul style="list-style-type: none"> <li>• acc. to DIN EN 81346-2</li> </ul>	S
<b>Design of the fuse link for short-circuit protection of the auxiliary switch with type of assignment 1 required</b>	gG / Dz 10 A, quick-acting / Dz 10 A
<b>Continuous current of the C characteristic MCB</b>	10 A; for a short-circuit current smaller than 400 A

#### Auxiliary circuit:

<b>Design of the contact of auxiliary contacts</b>	Silver alloy
<b>Number of NC contacts</b>	1
<ul style="list-style-type: none"> <li>• for auxiliary contacts</li> </ul>	1
<b>Number of NO contacts</b>	0
<ul style="list-style-type: none"> <li>• for auxiliary contacts</li> </ul>	0
<b>Number of CO contacts</b>	0
<ul style="list-style-type: none"> <li>• for auxiliary contacts</li> </ul>	0

#### Connections/ Terminals:

<b>Type of electrical connection</b>	Screw-type terminal
<ul style="list-style-type: none"> <li>• of modules and accessories</li> </ul>	Screw-type terminal
<b>Type of electrical connection on enclosure</b>	Cable routing above and below, both 1 x M20
<b>Tightening torque</b>	0.8 ... 0.9 N·m
<ul style="list-style-type: none"> <li>• with screw-type terminals</li> </ul>	0.8 ... 0.9 N·m

#### Interfaces:

<b>Design of the interface</b>	without
<ul style="list-style-type: none"> <li>• for communication</li> </ul>	without

#### Ambient conditions:

<b>Ambient temperature</b>	-25 ... +70 °C
<ul style="list-style-type: none"> <li>• during operation</li> </ul>	-25 ... +70 °C
<ul style="list-style-type: none"> <li>• during storage</li> </ul>	-40 ... +80 °C

#### Installation/ mounting/ dimensions:

<b>Mounting type</b>	Floor mounting
<ul style="list-style-type: none"> <li>• of modules and accessories</li> </ul>	Floor mounting
<b>Height</b>	85 mm
<b>Width</b>	85 mm
<b>Depth</b>	75 mm
<b>Shape of the installation opening</b>	round

#### Accessories:

<b>Number of labels</b>	1
<b>Marking of the name plate for command devices</b>	A = O
<b>Color of the label</b>	A = black

#### Certificates/approvals



CCC



CSA



UL



VDE



EG-Konf.

## other

[Bestätigungen](#)

## Further information

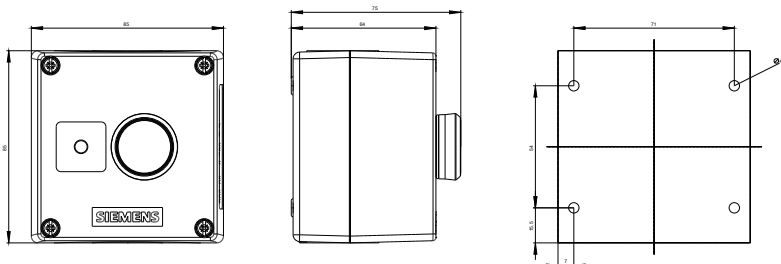
**Information- and Downloadcenter (Catalogs, Brochures,...)**<http://www.siemens.com/industrial-controls/catalogs>**Industry Mall (Online ordering system)**<https://mall.industry.siemens.com/mall/en/en/Catalog/product?mlfb=3SU18010AE002AB1>**Cax online generator**<http://support.automation.siemens.com/WW/CAXorder/default.aspx?lang=en&mlfb=3SU18010AE002AB1>**Service&Support (Manuals, Certificates, Characteristics, FAQs,...)**<https://support.industry.siemens.com/cs/ww/en/ps/3SU18010AE002AB1>**Image database (product images, 2D dimension drawings, 3D models, device circuit diagrams, EPLAN macros, ...)**[http://www.automation.siemens.com/bilddb/cax\\_de.aspx?mlfb=3SU18010AE002AB1&lang=en](http://www.automation.siemens.com/bilddb/cax_de.aspx?mlfb=3SU18010AE002AB1&lang=en)



SIEMENS

3SU18.1.(AC,AE)0\_01\_4\_IJC.V.DXF

Format / Size: Hybrid quer

**last modified:**

**08.01.2016**