

SIGNALLING COLUMN REP.-FLASH LIGHT ELEMENT
LED YELLOW, 24V AC/DC



General technical data:

product brand name		SIRIUS
Product designation		Repeated-flash light element
Product component Light source		Yes
Design of the optical signal		blinklight
Type of voltage of the operating voltage		AC/DC
Operating voltage		
• 1 at DC rated value	V	24
• 1 at AC at 50 Hz rated value	V	24
• 1 at AC at 60 Hz rated value	V	24
Equipment marking acc. to DIN EN 61346-2		P

Mechanical data:

Outer diameter of the signal column element	mm	70
---	----	----

Lamp:

Type of light source		LED
----------------------	--	-----

Ambient conditions:

Ambient temperature during operation	°C	-20 ... +50
Protection class IP		IP65

Height	mm	65.5
Width	mm	70

Certificates/ approvals:

General Product Approval	EMC	Declaration of Conformity	Shipping Approval	other
--------------------------	-----	---------------------------	-------------------	-------



[Bestätigungen](#)

Further information

Information- and Downloadcenter (Catalogs, Brochures,...)

<http://www.siemens.com/industrial-controls/catalogs>

Industry Mall (Online ordering system)

<http://www.siemens.com/industrymall>

Cax online generator

<http://support.automation.siemens.com/WW/CAXorder/default.aspx?lang=en&mlfb=8WD44205BD>

Service&Support (Manuals, Certificates, Characteristics, FAQs,...)

<https://support.industry.siemens.com/cs/ww/en/ps/8WD44205BD>

Image database (product images, 2D dimension drawings, 3D models, device circuit diagrams, EPLAN macros, ...)

http://www.automation.siemens.com/bilddb/cax_de.aspx?mlfb=8WD44205BD&lang=en

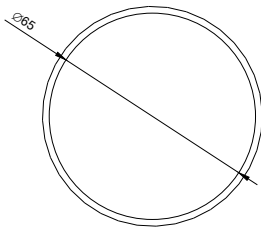
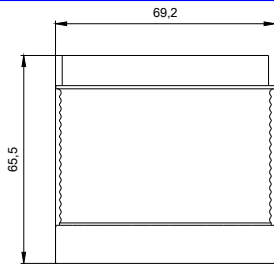

WB:8333: 8WD44-..._ALL



last modified:

23.11.2015