

PARALLEL CONNECTION WITH TERMINAL, 3-POLE  
FOR 3RT.03

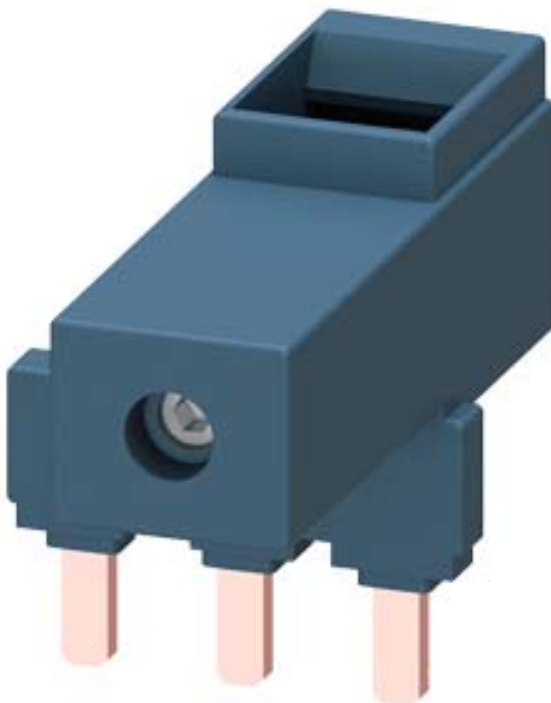





General technical data:

product brand name	SIRIUS
Product designation	Infeed terminal
Design of the product	Parallel switching connection for contactors S2
Size of contactor	S2

Installation/ mounting/ dimensions:

Mounting type	screw fixing
---------------	--------------

Certificates/ approvals:

General Product Approval			Declaration of Conformity	Test Certificates	
 CSA	 UL		 EG-Konf.	<a href="#">Typprüfbescheinigung/Werkszeugnis</a>	<a href="#">spezielle Prüfbescheinigungen</a>

Shipping Approval					other
 ABS	 BUREAU VERITAS	 GL	 PRS	 RINA	<a href="#">Umweltbestätigung</a>

other	
<a href="#">Bestätigungen</a>	<a href="#">sonstig</a>

#### Further information

**Information- and Downloadcenter (Catalogs, Brochures,...)**

<http://www.siemens.com/industrial-controls/catalogs>

**Industry Mall (Online ordering system)**

<http://www.siemens.com/industrymall>

**Cax online generator**

<http://support.automation.siemens.com/WW/CAXorder/default.aspx?lang=en&mlfb=3RT19364BB31>

**Service&Support (Manuals, Certificates, Characteristics, FAQs,...)**

<https://support.industry.siemens.com/cs/ww/en/ps/3RT19364BB31>

**Image database (product images, 2D dimension drawings, 3D models, device circuit diagrams, EPLAN macros, ...)**

[http://www.automation.siemens.com/bilddb/cax\\_de.aspx?mlfb=3RT19364BB31&lang=en](http://www.automation.siemens.com/bilddb/cax_de.aspx?mlfb=3RT19364BB31&lang=en)

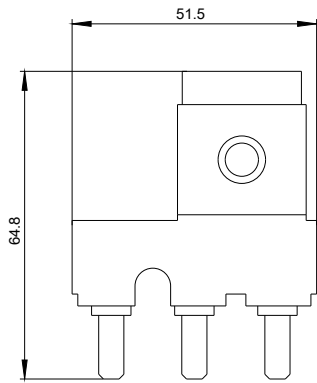

last modified:

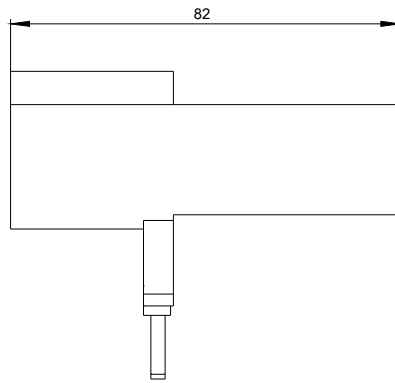

13.08.2015