

ENCLOSURE FOR COMMAND DEVICES, 22MM, ROUND, ENCLOSURE MATERIAL PLASTIC, ENCLOSURE TOP PART YELLOW, 1 COMMAND POINT PLASTIC, WITH PROTECTIVE COLLAR, A=EM. STOP MUSH. PUSHB. RED, 40MM, ROTATE TO UNLATCH, 1NC, SCREW TERMINAL, BASE MOUNTING,



Figure similar

<b>product brand name</b>	SIRIUS ACT
<b>Product designation</b>	Commanding and signaling devices
<b>Design of the product</b>	Enclosure
<b>Manufacturer article number</b>	<ul style="list-style-type: none"> <li>• of supplied contact module at the command point A 1 <a href="#">3SU1400-2AA10-1CA0</a></li> <li>• of the supplied holder at the command point A <a href="#">3SU1500-0AA10-0AA0</a></li> <li>• of the supplied actuator at the command point A <a href="#">3SU1000-1HB20-0AA0</a></li> <li>• of supplied empty enclosure <a href="#">3SU1801-0AA00-0AC2</a></li> </ul>

Enclosure:	
<b>Design of the housing</b>	with protective collar
<b>Shape of the enclosure front</b>	Square
<b>Material of the enclosure</b>	plastic
<b>Number of command points</b>	1
<b>Product component</b>	
<ul style="list-style-type: none"> <li>• EMERGENCY STOP device</li> <li>• protective collar</li> </ul>	<p>No</p> <p>No</p>
<b>Color</b>	

<ul style="list-style-type: none"> <li>• of top part of the enclosure</li> </ul>	yellow
<b>Delivery state</b>	
<ul style="list-style-type: none"> <li>• as a kit</li> </ul>	No
<ul style="list-style-type: none"> <li>• pre-wired on strip terminal</li> </ul>	No
<b>Mounting type of the enclosure</b>	Vertical

#### Actuator:

<b>Design of the operating mechanism</b>	EMERGENCY STOP mushroom pushbutton
<b>Product feature</b>	
<ul style="list-style-type: none"> <li>• lockout</li> </ul>	No
<b>Product expansion optional Light source</b>	No
<b>Color</b>	
<ul style="list-style-type: none"> <li>• of the actuating element</li> </ul>	Red
<b>Material of the actuating element</b>	plastic
<b>Shape of the actuating element</b>	round
<b>Number of contact modules</b>	1

#### Front ring:

<b>Product component front ring</b>	No
<b>Design of the front ring</b>	Standard

#### Holder:

<b>Material of the holder</b>	Plastic
-------------------------------	---------

#### Display:

<b>Number of LED modules</b>	0
------------------------------	---

#### General technical data:

<b>Product function</b>	
<ul style="list-style-type: none"> <li>• positive opening</li> </ul>	Yes
<ul style="list-style-type: none"> <li>• EMERGENCY OFF function</li> </ul>	Yes
<ul style="list-style-type: none"> <li>• EMERGENCY STOP function</li> </ul>	Yes
<b>Protection class IP</b>	IP66, IP67, IP69(IP69K)
<b>Degree of protection NEMA</b>	NEMA 1, 2, 3, 3R, 4, 4X, 12
<b>Shock resistance</b>	
<ul style="list-style-type: none"> <li>• acc. to IEC 60068-2-27</li> </ul>	Sinusoidal half-wave 50 g / 11 ms
<ul style="list-style-type: none"> <li>• for railway applications acc. to DIN EN 61373</li> </ul>	Category 1, Class B
<b>Vibration resistance</b>	
<ul style="list-style-type: none"> <li>• acc. to IEC 60068-2-6</li> </ul>	10 ... 500 Hz: 5g
<ul style="list-style-type: none"> <li>• for railway applications acc. to DIN EN 61373</li> </ul>	Category 1, Class B
<b>Equipment marking</b>	
<ul style="list-style-type: none"> <li>• acc. to DIN EN 61346-2</li> </ul>	S
<ul style="list-style-type: none"> <li>• acc. to DIN EN 81346-2</li> </ul>	S
<b>Design of the fuse link for short-circuit protection of the auxiliary switch with type of assignment 1 required</b>	gG / Dz 10 A, quick-acting / Dz 10 A

<b>Continuous current of the C characteristic MCB</b>	10 A
<b>Auxiliary circuit:</b>	
<b>Design of the contact of the auxiliary contacts</b>	Silver alloy
<b>Number of NC contacts</b> • for auxiliary contacts	1
<b>Number of NO contacts</b> • for auxiliary contacts	0
<b>Number of CO contacts</b> • for auxiliary contacts	0
<b>Connections/ Terminals:</b>	
<b>Type of electrical connection</b> • of modules and accessories	Screw-type terminal
<b>Type of electrical connection on enclosure</b>	Cable routing above and below, both 1 x M20
<b>Tightening torque</b> • with screw-type terminals	0.8 ... 0.9 N·m
<b>Interfaces:</b>	
<b>Design of the interface</b> • for communication	without
<b>Ambient conditions:</b>	
<b>Ambient temperature</b> • during operation • during storage	-25 ... +70 °C -40 ... +80 °C
<b>Environmental category during operation acc. to IEC 60721</b>	3K6, 3C3, 3S2, 3M6
<b>Installation/ mounting/ dimensions:</b>	
<b>Mounting type</b> • of modules and accessories	Floor mounting
<b>Height</b>	85 mm
<b>Width</b>	85 mm
<b>Depth</b>	112.5 mm
<b>Shape of the installation opening</b>	round
<b>Accessories:</b>	
<b>Number of labels</b>	0
<b>Marking of the name plate for command devices</b>	A = I
<b>Certificates/ approvals:</b>	

General Product Approval	Declaration of Conformity	other
--------------------------	---------------------------	-------



[Bestätigungen](#)

### Further information

**Information- and Downloadcenter (Catalogs, Brochures,...)**

<http://www.siemens.com/industrial-controls/catalogs>

**Industry Mall (Online ordering system)**

<https://mall.industry.siemens.com/mall/en/en/Catalog/product?mlfb=3SU18010NA002AC2>

**Cax online generator**

<http://support.automation.siemens.com/WW/CAXorder/default.aspx?lang=en&mlfb=3SU18010NA002AC2>

**Service&Support (Manuals, Certificates, Characteristics, FAQs,...)**

<https://support.industry.siemens.com/cs/ww/en/ps/3SU18010NA002AC2>

**Image database (product images, 2D dimension drawings, 3D models, device circuit diagrams, EPLAN macros, ...)**

[http://www.automation.siemens.com/bilddb/cax\\_de.aspx?mlfb=3SU18010NA002AC2&lang=en](http://www.automation.siemens.com/bilddb/cax_de.aspx?mlfb=3SU18010NA002AC2&lang=en)

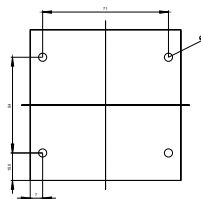
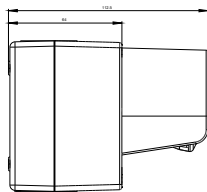
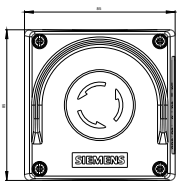

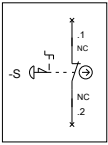

SIEMENS

3SU18.1.NA0\_01\_4\_IEC.DXF

**last modified:**

12.10.2015