

ELECTRONIC POTENTIOMETER W. OFF
 PUSHBUTTON 6A FM, 1-10V CONTROL INPUT 0.04A
 SCREW TERMINALS F. CLAW A. SCREW FIXING



Model		
Type of load		capacitive load
Type of composition		basic element
Design of the operating mechanism		rotary knob/button
Design of dimmer / Series dimmer		No
General technical data		
Operating apparent output / Rated value		
• minimum	V·A	920
• maximum	V·A	920
Dim power / minimum	V·A	0
Mounting type		Claw and screw fixing
Surface processing		other
Material		other
Protection class		
Protection class IP		IP20
Electricity		
Dim power / maximum	V·A	0
Main circuit		

Operating frequency / Rated value

- minimum
- maximum

Hz	50
Hz	50

Operating voltage

- Rated value

V	230
---	-----

Suitability**Suitability for interaction**

- motion detector
- wireless pushbutton
- IR pushbutton
- presence detector
- Pushbutton
- time switch

No
No
No
No
No
No

Appearance

- Color

miscellaneous

Product details**Product component**

- Light value memory
- Extension input

No
No

Product property

- halogen-free
- transparent

Yes
No

Connections**Mechanical Design****Height**

mm	70
----	----

Width

mm	70
----	----

Depth

mm	35
----	----

Mounting type

flush mounting

Material

- of the enclosure

metal

General Product Approval**Further information****Information- and Downloadcenter (Catalogs, Brochures,...)**

<http://www.siemens.com/lowvoltage/catalogs>

Industry Mall (Online ordering system)

<https://eb.automation.siemens.com/mall/en/WW/Catalog/Product/5TC8424>

Service&Support (Manuals, Certificates, Characteristics, FAQs,...)

<http://support.automation.siemens.com/WW/view/en/5TC8424/all>

Image database (product images, 2D dimension drawings, 3D models, device circuit diagrams, ...)

http://www.automation.siemens.com/bilddb/cax_en.aspx?mfb=5TC8424

CAX-Online-Generator

<http://www.siemens.com/cax>

Tender specifications

<http://ausschreibungstexte.siemens.com/tiplv>

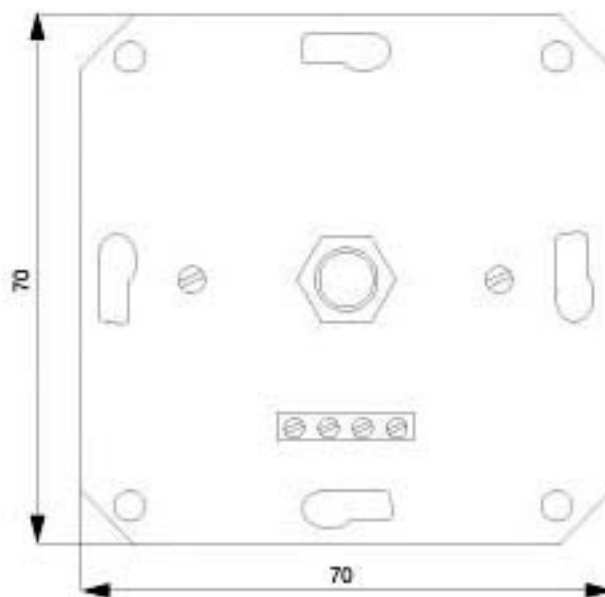

last modified:

21.10.2014