

PARALLEL CONNECTION WITHOUT TERMINAL,
3-POLE FOR 3RT202.,
SPRING-LOADED TERMINAL

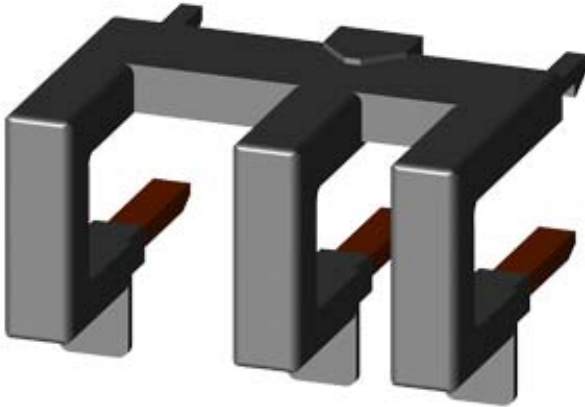

General technical data:	
product brand name	SIRIUS
Product designation	Connection jumper
Size of contactor	S0
Design of the product	Parallel switching connection for contactors S0, spring-loaded

Installation/mounting/dimensions:	
Mounting type	clip-on

Certificates/approvals:	
-------------------------	--

General Product Approval			Declaration of Conformity	Test Certificates
--------------------------	--	--	---------------------------	-------------------



[Special Test Certificate](#)

Shipping Approval



Shipping Approval

other



[Confirmation](#)



[Environmental Confirmations](#)

Further information:

Information- and Downloadcenter (Catalogs, Brochures,...)

<http://www.siemens.com/industrial-controls/catalogs>

Industry Mall (Online ordering system)

<http://www.siemens.com/industrial-controls/mall>

CAX-Online-Generator

<http://www.siemens.com/cax>

Service&Support (Manuals, Certificates, Characteristics, FAQs,...)

<http://support.automation.siemens.com/WW/view/en/3RT2926-4BA32/all>

Image database (product images, 2D dimension drawings, 3D models, device circuit diagrams, ...)

http://www.automation.siemens.com/bilddb/cax_en.aspx?mlfb=3RT2926-4BA32

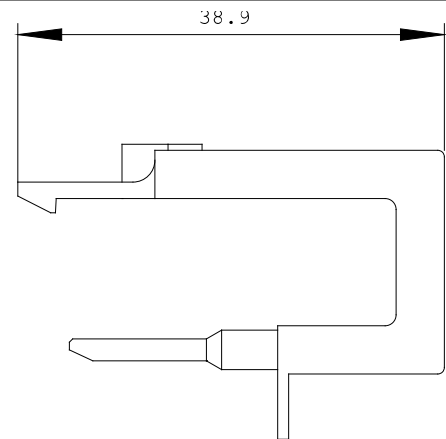
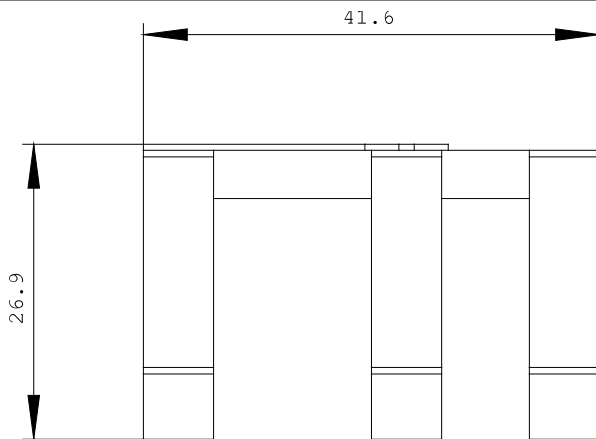

last change:

Nov 17, 2014