



TEMPERATURE MONITORING RELAY THERMOCOUPLE
 J,K,T,E,N,S,R,B,
 2 THRESHOLDS, DIGITAL,
 -99 DEGREES C TO 1800 DEGREES C (SENSOR-
 DEPENDENT),
 24 V TO 240 V AC/DC, 2 X 1 CO + 1 NO,
 WIDTH 45 MM, SCREW TERMINAL

General technical details:

| | | |
|---|--|---|
| Type of voltage | | AC/DC |
| Supply voltage frequency | | |
| <ul style="list-style-type: none"> • 1 / for auxiliary and control current circuit <ul style="list-style-type: none"> • initial rated value • final rated value • 1 / at 50 Hz / for AC / initial rated value • 1 / at 50 Hz / for AC / final rated value • 1 / at 60 Hz / for AC / initial rated value • 1 / at 60 Hz / for AC / final rated value • 1 / for DC / initial rated value • 1 / for DC / final rated value | <ul style="list-style-type: none"> Hz Hz V V V V V V | <ul style="list-style-type: none"> 50 60 24 240 24 240 24 240 |
| Product function | | |
| <ul style="list-style-type: none"> • defect storage • reset external | | <ul style="list-style-type: none"> Yes Yes |
| Number of measuring circuits | | 1 |
| Number of NC contacts / for auxiliary contacts | | 0 |
| Number of NO contacts / for auxiliary contacts | | 1 |
| Number of changeover contacts / for auxiliary contacts | | 2 |
| Measurable temperature | | |

| | | |
|---|----|-------------|
| • initial value | °C | -99 |
| • final value | °C | 1,800 |
| Reference code / according to DIN EN 61346-2 | | K |
| Reference code / according to DIN 40719 extended according to IEC 204-2 / according to IEC 750 | | K |
| Ambient temperature | | |
| • during operating | °C | -25 ... +60 |

Mechanical design:

| | | |
|---|----|-----------------------------------|
| Design of the electrical connection | | |
| • for auxiliary and control current circuit | | screw-type terminals |
| • jumper socket | | Yes |
| Design of the sensor / connectable | | type J, K, T, E, N (thermocouple) |
| Width | mm | 45 |
| Height | mm | 106 |
| Depth | mm | 91 |

Certificates/approvals:

General Product Approval



other

[Declaration of Conformity](#)

[Environmental Confirmations](#)

Further information:

Information- and Downloadcenter (Catalogs, Brochures,...)

<http://www.siemens.com/industrial-controls/catalogs>

Industry Mall (Online ordering system)

<http://www.siemens.com/industrial-controls/mall>

Cax online generator:

<http://www.siemens.com/cax>

Service&Support (Manuals, Certificates, Characteristics, FAQs,...)

<http://support.automation.siemens.com/WW/view/en/3RS1142-1GW80/all>

Image database (product images, 2D dimension drawings, 3D models, device circuit diagrams, ...)

http://www.automation.siemens.com/bilddb/cax_en.aspx?mlfb=3RS1142-1GW80

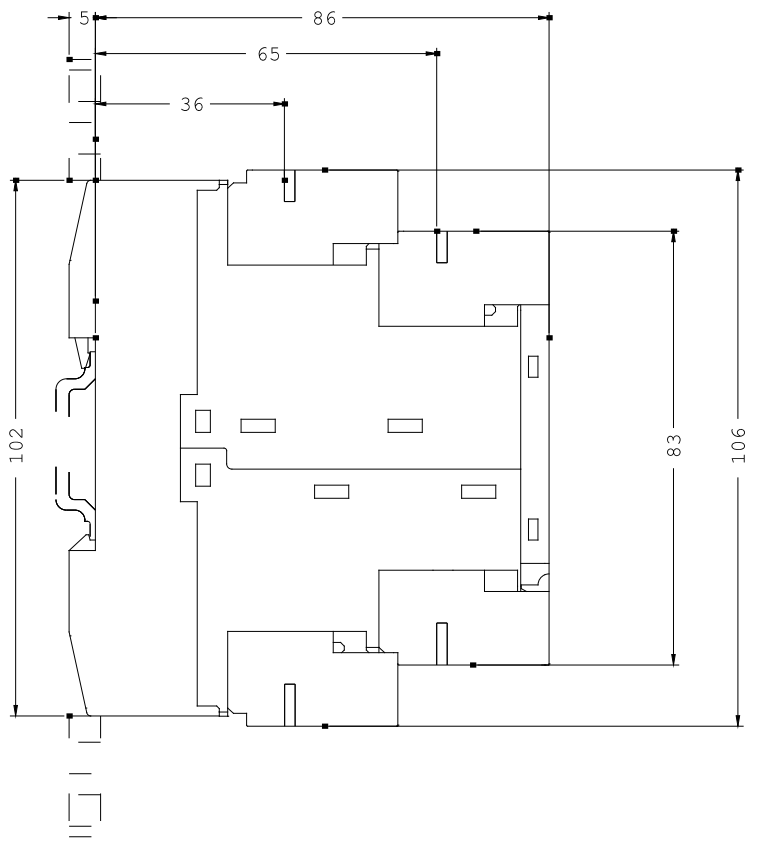
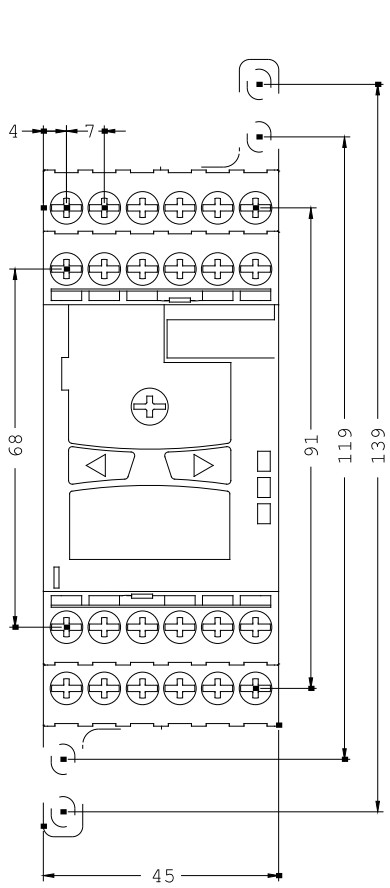

last change:

Jul 28, 2014