



TEMPERATURE MONITORING RELAY PT100/1000,
 KTY83/84, NTC 3 SENSORS, 2 THR. VAL.,
 DIGITAL -50 DEG. C TO 500 DEG. C 24-240V AC/DC 2 X 1
 W + 1 NO,
 WIDTH 45 MM SCREW CONNECTION

General technical details:



Type of voltage		AC/DC
Supply voltage frequency		
<ul style="list-style-type: none"> • 1 / for auxiliary and control current circuit • initial rated value • final rated value • 1 / at 50 Hz / for AC / initial rated value • 1 / at 50 Hz / for AC / final rated value • 1 / at 60 Hz / for AC / initial rated value • 1 / at 60 Hz / for AC / final rated value • 1 / for DC / initial rated value • 1 / for DC / final rated value 	Hz Hz V V V V V V	50 60 24 240 24 240 24 240
Number of measuring circuits		3
Product function		
<ul style="list-style-type: none"> • defect storage • reset external 		Yes Yes
Measurable temperature		
<ul style="list-style-type: none"> • initial value • final value 	°C °C	-50 500
Reference code / according to DIN EN 61346-2		K

Reference code / according to DIN 40719 extended according to IEC 204-2 / according to IEC 750		K
Ambient temperature • during operating	°C	-25 ... +60

Mechanical design:

Design of the electrical connection • for auxiliary and control current circuit • jumper socket		screw-type terminals Yes
Design of the sensor / connectable		PT100/1000, KTY83/84, NTC (resistance sensors)
Number of NC contacts / for auxiliary contacts		0
Number of NO contacts / for auxiliary contacts		1
Number of changeover contacts / for auxiliary contacts		2
Width	mm	45
Height	mm	106
Depth	mm	91

Certificates/approvals:

General Product Approval	Test Certificates	other
 CCC		 UL
	Special Test Certificate	Declaration of Conformity
		Environmental Confirmations

Further information:

Information- and Downloadcenter (Catalogs, Brochures,...) http://www.siemens.com/industrial-controls/catalogs
Industry Mall (Online ordering system) http://www.siemens.com/industrial-controls/mall
Cax online generator: http://www.siemens.com/cax
Service&Support (Manuals, Certificates, Characteristics, FAQs,...) http://support.automation.siemens.com/WW/view/en/3RS1041-1GW50/all
Image database (product images, 2D dimension drawings, 3D models, device circuit diagrams, ...) http://www.automation.siemens.com/bilddb/cax_en.aspx?mlfb=3RS1041-1GW50

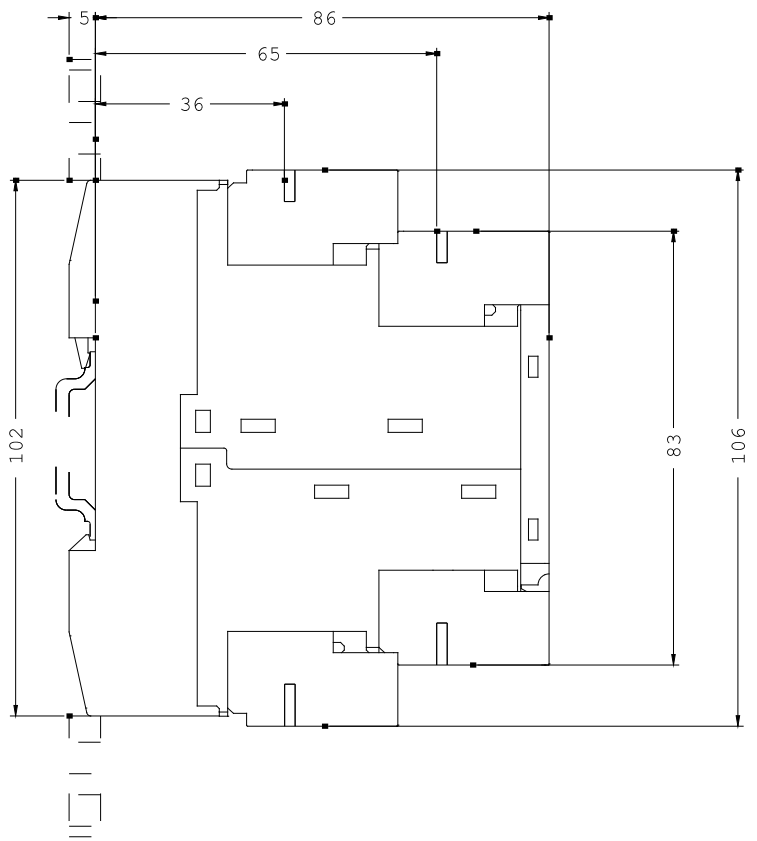
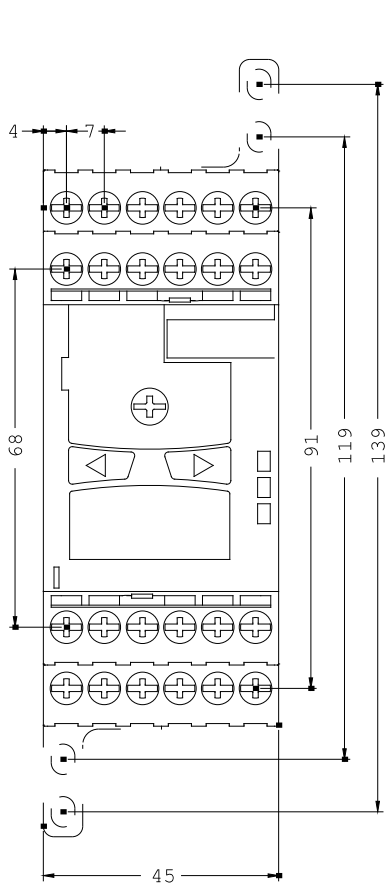

last change:

Jul 28, 2014