

# Contact M16 / M23 Signal crimp socket 1 mm

Item number 7010901002

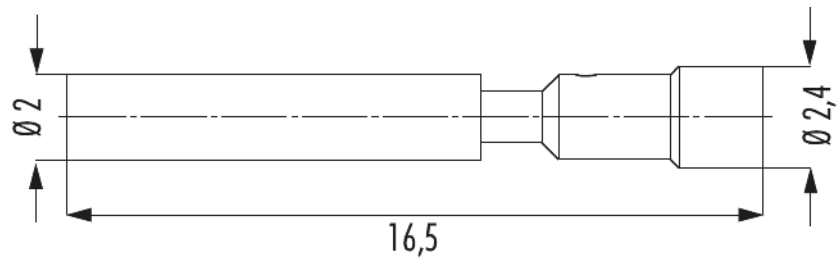
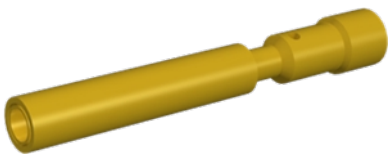

## Technical data

Characteristic of connection	Crimp
Insert	Socket
Crimp contact	Crimp socket signal 1 mm machined
Material contact	Copper-zinc alloy
Material contact surface	nickel, gold plated (0.25 µm)
Contact-Ø signal	1 mm
Length (L)	16.5 mm
Crimp range	0.34 - 1 mm <sup>2</sup>
Suitable crimping tool	7000900904

# Contact M16 / M23 Signal crimp socket 1 mm

Item number 7010901002

## Commercial data

Packaging Unit	100
EAN code	4033878501993
Weight	0.00047 kg
ETIM 7	EC000796
ETIM 8	EC000796
ETIM 9	EC000796
eCl@ss 10.1	27440204
Customs tariff number	85366990

Note: