

Position switch Plastic enclosure according to EN 50047, 50 mm
 Device connection 2 x (M20 x 1.5) 1 NO/2 NC slow-action contacts
 Rounded plunger/Teflon plunger



| | |
|--------------------------------------|--|
| Product brand name | SIRIUS |
| Product designation | Mechanical position switches |
| Product type designation | 3SE5 |
| Manufacturer's article number | <ul style="list-style-type: none"> • of the supplied basic switch 3SE5242-0KC05 • of the supplied switching contacts 3SE5000-0KA00 • of the supplied empty enclosure with cover 3SE5242-0AC05 |
| Suitability for use safety switch | Yes |

| General technical data | |
|--|--------------|
| Product function | |
| <ul style="list-style-type: none"> • positive opening | Yes |
| Insulation voltage | |
| <ul style="list-style-type: none"> • rated value | 400 V |
| Degree of pollution | class 3 |
| Surge voltage resistance rated value | 6 kV |
| Protection class IP | IP66/IP67 |
| Shock resistance | |
| <ul style="list-style-type: none"> • acc. to IEC 60068-2-27 | 30 g / 11 ms |
| Vibration resistance | |

| | |
|--|--|
| <ul style="list-style-type: none"> • acc. to IEC 60068-2-6 | 0.35 mm/5g |
| Mechanical service life (switching cycles) | |
| <ul style="list-style-type: none"> • typical | 15 000 000 |
| Electrical endurance (switching cycles) | |
| <ul style="list-style-type: none"> • at AC-15 at 230 V typical | 100 000 |
| Electrical endurance (switching cycles) with contactor 3RH11, 3RT1016, 3RT1017, 3RT1024, 3RT1025, 3RT1026 typical | 10 000 000 |
| Electrical operating cycles in one hour with contactor 3RH11, 3RT1016, 3RT1017, 3RT1024, 3RT1025, 3RT1026 | 6 000 |
| Thermal current | 10 A |
| Material of the enclosure of the switch head | plastic |
| Continuous current of the C characteristic MCB | 1 A; for a short-circuit current smaller than 400 A |
| Continuous current of the quick DIAZED fuse link | 10 A; for a short-circuit current smaller than 400 A |
| Continuous current of the DIAZED fuse link gG | 6 A |
| Active principle | mechanical |
| Repeat accuracy | 0.05 mm |
| Minimum actuating force in activation direction | 20 N |
| Length of the sensor | 60.7 mm |
| Width of the sensor | 50 mm |
| Design of the switching contact | mechanical |
| Operating frequency rated value | 50 ... 60 Hz |
| Number of NC contacts for auxiliary contacts | 2 |
| Number of NO contacts for auxiliary contacts | 1 |
| Number of CO contacts for auxiliary contacts | 1 |
| Operating current at AC-15 | |
| <ul style="list-style-type: none"> • at 24 V rated value | 6 A |
| <ul style="list-style-type: none"> • at 240 V rated value | 6 A |
| <ul style="list-style-type: none"> • at 400 V rated value | 4 A |
| Operating current at DC-13 | |
| <ul style="list-style-type: none"> • at 24 V rated value | 3 A |
| <ul style="list-style-type: none"> • at 125 V rated value | 0.55 A |
| <ul style="list-style-type: none"> • at 250 V rated value | 0.27 A |
| <ul style="list-style-type: none"> • at 400 V rated value | 0.12 A |
| Design of the interface for safety-related communication | without |

Enclosure

| | |
|---|-------------|
| Design of the housing | block, wide |
| Material of the enclosure | plastic |
| Coating of the enclosure | Other types |
| Design of the housing acc. to standard | No |

Drive Head

| | |
|---|---------------------------------|
| Design of the operating mechanism | Rounded plunger, Teflon plunger |
| Standard-compliant actuator head | EN 50047, design B |
| Shape of the switch head | rounded |
| Design of the switching function | positive opening |
| Circuit principle | slow-action contacts |
| Number of switching contacts safety-related | 2 |

Connections/Terminals

| | |
|--|---|
| Type of electrical connection | screw-type terminals |
| Type of connectable conductor cross-sections | |
| <ul style="list-style-type: none"> • solid | 1x (0.5 ... 1.5 mm ²), 2x (0.5 ... 0.75 mm ²) |
| <ul style="list-style-type: none"> • finely stranded with core end processing | 1x (0.5 ... 1.5 mm ²), 2x (0.5 ... 0.75 mm ²) |
| <ul style="list-style-type: none"> • at AWG conductors solid | 1x (20 ... 16), 2x (20 ... 18) |
| <ul style="list-style-type: none"> • at AWG conductors stranded | 1x (20 ... 16), 2x (20 ... 18) |
| Cable entry type | 2 x (M20 x 1.5) |

Communication/ Protocol

| | |
|-------------------------|---------|
| Design of the interface | without |
|-------------------------|---------|

Ambient conditions

| | |
|--|----------------|
| Ambient temperature | |
| <ul style="list-style-type: none"> • during operation | -25 ... +85 °C |
| <ul style="list-style-type: none"> • during storage | -40 ... +90 °C |
| Explosion protection category for dust | none |

Installation/ mounting/ dimensions

| | |
|---|--------------|
| <ul style="list-style-type: none"> • (mounting position) | any |
| <ul style="list-style-type: none"> • (mounting type) | screw fixing |

Certificates/approvals

| | | |
|--------------------------|---------------------------------------|---------------------------|
| General Product Approval | Functional Safety/Safety of Machinery | Declaration of Conformity |
|--------------------------|---------------------------------------|---------------------------|



[Type Examination Certificate](#)



| | | |
|---------------------------|-------------------|-------|
| Declaration of Conformity | Test Certificates | other |
|---------------------------|-------------------|-------|

[Miscellaneous](#)

[Type Test Certificates/Test Report](#)

[Confirmation](#)

Further information

Information- and Downloadcenter (Catalogs, Brochures,...)

<http://www.siemens.com/industrial-controls/catalogs>

Industry Mall (Online ordering system)

<https://mall.industry.siemens.com/mall/en/en/Catalog/product?mfb=3SE5242-0KC05>

Cax online generator

<http://support.automation.siemens.com/WW/CAXorder/default.aspx?lang=en&mfb=3SE5242-0KC05>

Service&Support (Manuals, Certificates, Characteristics, FAQs,...)

<https://support.industry.siemens.com/cs/ww/en/ps/3SE5242-0KC05>

Image database (product images, 2D dimension drawings, 3D models, device circuit diagrams, EPLAN macros, ...)

http://www.automation.siemens.com/bilddb/cax_de.aspx?mfb=3SE5242-0KC05&lang=en

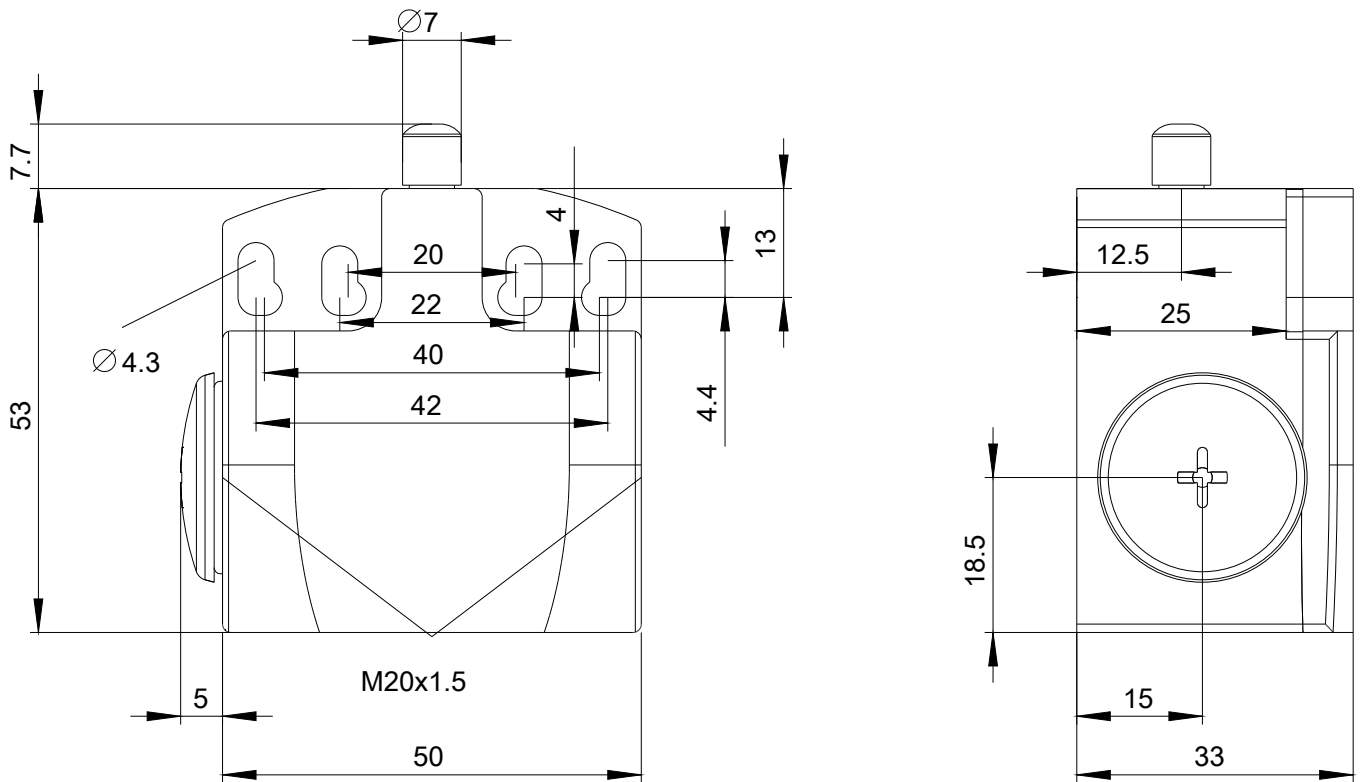

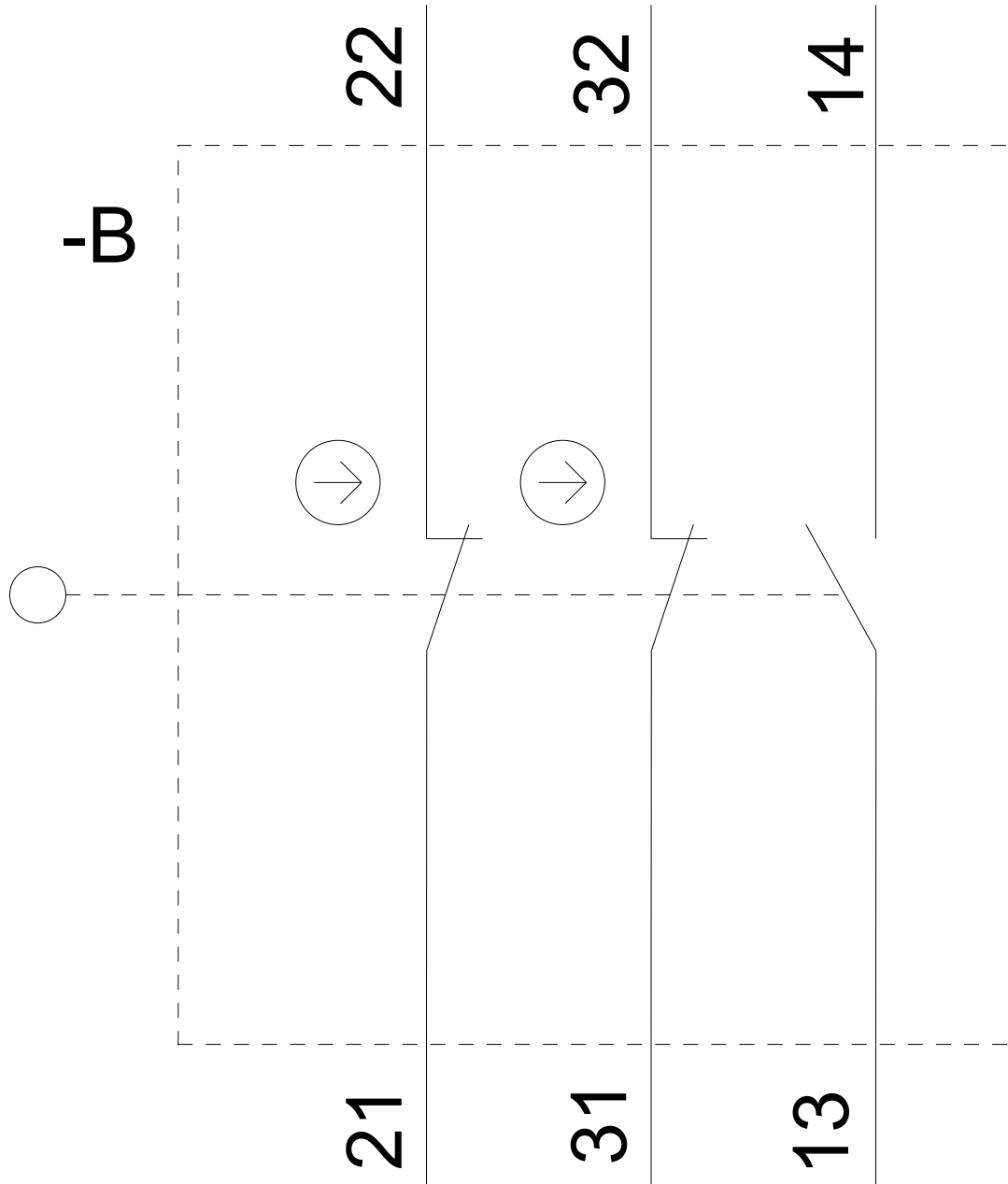

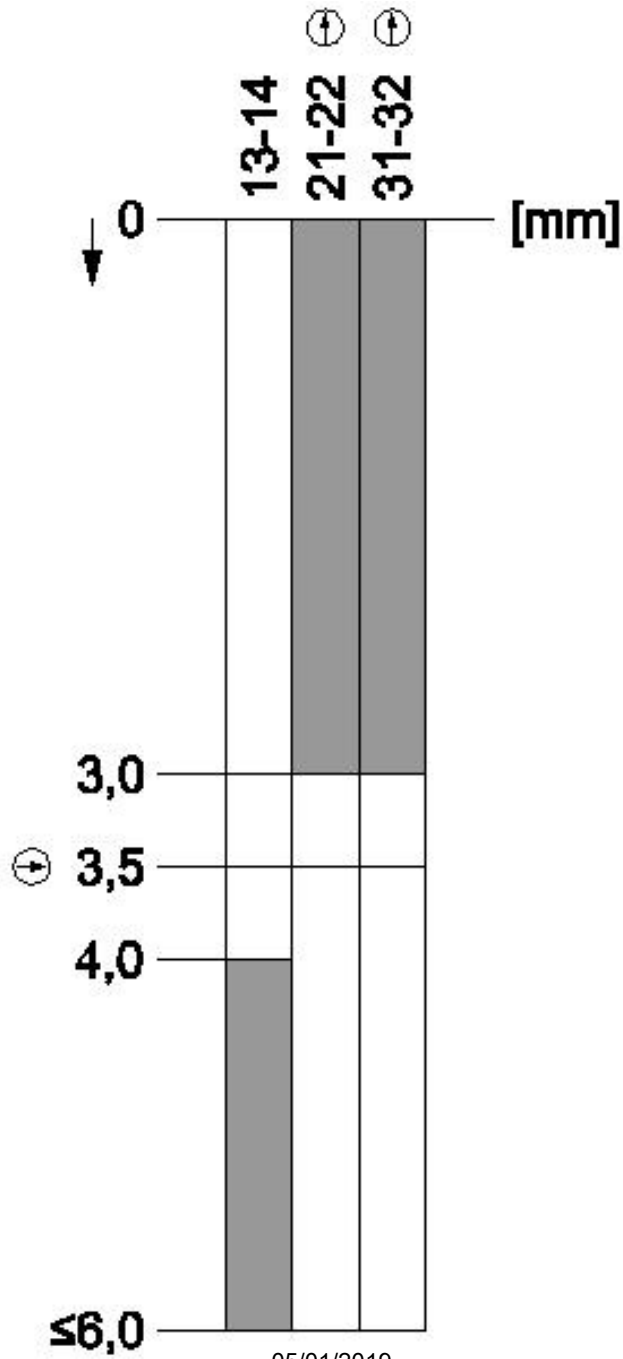

last modified:

05/01/2019