

Solenoid, rectangular large 25 x 88 mm for Magnet switch 3SE66.7-2CA0. Position: is mounted offset by 90° from the contact block



Product brand name	SIRIUS
Product designation	Magnetically operated switch
Design of the product	Coded magnet, rectangular
Product type designation	3SE67

General technical data

Product feature	90° offset
Protection class IP	IP67
Height of the sensor	25 mm
Length of the sensor	7 mm
Width of the sensor	88 mm

Enclosure

Material of the enclosure	plastic
---------------------------	---------

Ambient conditions

Ambient temperature	
<ul style="list-style-type: none"> during operation 	-25 ... +70 °C
<ul style="list-style-type: none"> during storage and transport 	-25 ... +70 °C

Installation/ mounting/ dimensions

Mounting type	screw fixing
---------------	--------------

Certificates/approvals

General Product Approval

other



[Confirmation](#)

Further information

Information- and Downloadcenter (Catalogs, Brochures,...)

<http://www.siemens.com/industrial-controls/catalogs>

Industry Mall (Online ordering system)

<https://mall.industry.siemens.com/mall/en/en/Catalog/product?mlfb=3SE6724-2CA>

Cax online generator

<http://support.automation.siemens.com/WW/CAXorder/default.aspx?lang=en&mlfb=3SE6724-2CA>

Service&Support (Manuals, Certificates, Characteristics, FAQs,...)

<https://support.industry.siemens.com/cs/ww/en/ps/3SE6724-2CA>

Image database (product images, 2D dimension drawings, 3D models, device circuit diagrams, EPLAN macros, ...)

http://www.automation.siemens.com/bilddb/cax_de.aspx?mlfb=3SE6724-2CA&lang=en

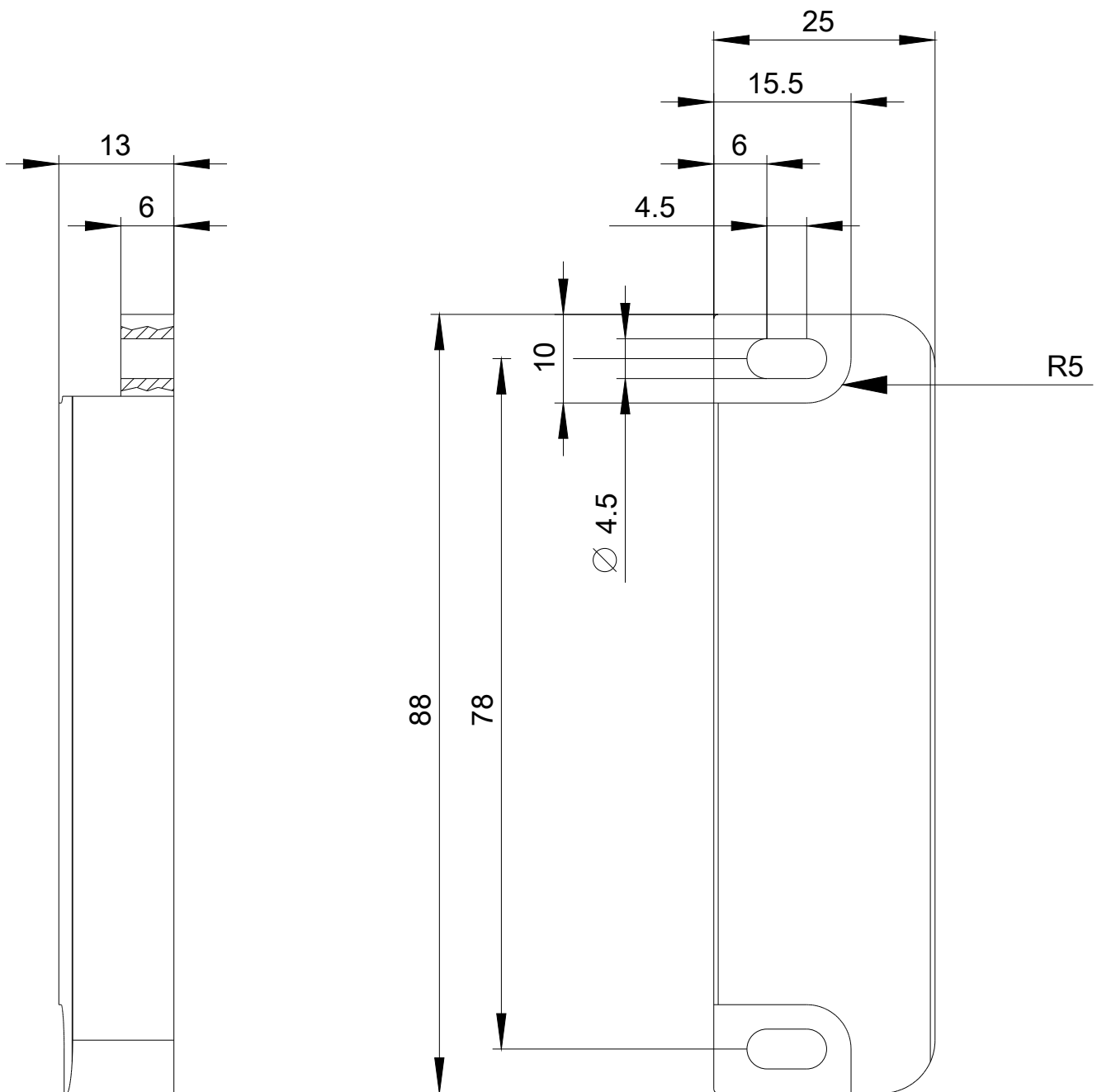

last modified:

01/20/2019