

Washer for emergency stop, yellow, Outer diameter 60 mm, Inside diameter 22.5 mm, Thickness 2 mm, with inscription: EMERGENCY STOP, EMERGENCY STOP, ARRÊT D'URGENCE, EMERGENZA 4 languages: DE,EN,FR,IT



Figure similar

Product brand name	SIRIUS ACT
Product designation	EMERGENCY STOP plate
Product type designation	3SU1





### General technical data

Shock resistance	
<ul style="list-style-type: none"> <li>for railway applications acc. to DIN EN 61373</li> </ul>	Category 1, Class B
Vibration resistance	
<ul style="list-style-type: none"> <li>for railway applications acc. to DIN EN 61373</li> </ul>	Category 1, Class B

### Accessories

Material of accessory	Plastic
Mounting type of label	without
Marking of backing plate	NOT-HALT, EMERGENCY STOP, ARRÊT D'URGENCE, EMERGENZA (de, en, fr, it)
Shape of backing plate	Round
Color of backing plate	yellow/black (plate/text)
Product function Illuminated backing plate	No

### Certificates/approvals

General Product Approval	Declaration of Conformity	Test Certificates
 CSA  UL	  EG-Konf.	<a href="#">Special Test Certificate</a> <a href="#">Type Test Certificates/Test Report</a>

**other**

[Confirmation](#)

**Further information**

**Information- and Downloadcenter (Catalogs, Brochures,...)**

<http://www.siemens.com/industrial-controls/catalogs>

**Industry Mall (Online ordering system)**

<https://mall.industry.siemens.com/mall/en/en/Catalog/product?mlfb=3SU1900-0BN31-0NC0>

**Cax online generator**

<http://support.automation.siemens.com/WW/CAXorder/default.aspx?lang=en&mlfb=3SU1900-0BN31-0NC0>

**Service&Support (Manuals, Certificates, Characteristics, FAQs,...)**

<https://support.industry.siemens.com/cs/ww/en/ps/3SU1900-0BN31-0NC0>

**Image database (product images, 2D dimension drawings, 3D models, device circuit diagrams, EPLAN macros, ...)**

[http://www.automation.siemens.com/bilddb/cax\\_de.aspx?mlfb=3SU1900-0BN31-0NC0&lang=en](http://www.automation.siemens.com/bilddb/cax_de.aspx?mlfb=3SU1900-0BN31-0NC0&lang=en)

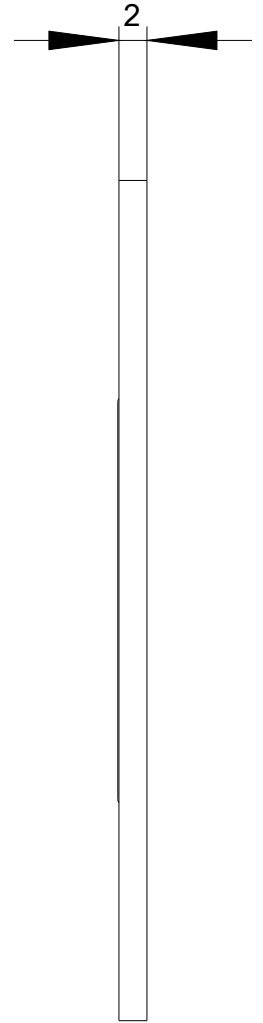
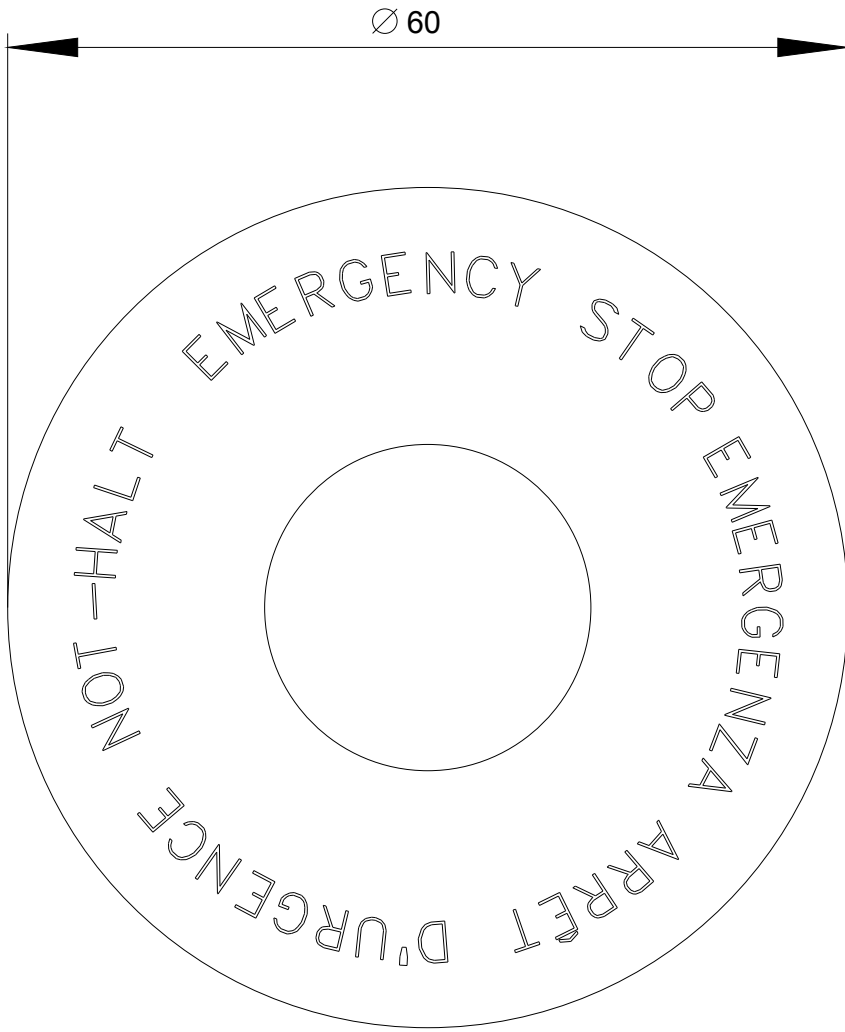

last modified:

11/07/2018