

Single-flash light element, w. built-in electronic flash, blue, 24 V DC,
Diameter 70 mm



General technical data	
Product brand name	SIRIUS
Product designation	Flashlight element
Design of the optical signal	flash light
Type of voltage of the operating voltage	DC
Operating voltage	
• 1 at DC rated value	24 V
Relative positive tolerance of the operating voltage	10 %
Relative negative tolerance of the operating voltage	-10 %
Consumed current maximum	20 mA
Color	blue
Mounting type	Bayonet
• Reference identifier acc. to DIN EN 61346-2	P
• Reference identifier acc. to DIN EN 81346-2	P
Mechanical data	
Outer diameter of the signal column element	70 mm
Lamp	
Product component Light source	Yes

Type of light source	Xenon gas discharge lamp
Flash frequency	1 Hz
Number of flashes of light element	4 000 000
Light intensity	44 261 cd

Ambient conditions

Ambient temperature during operation	-20 ... +50 °C
Protection class IP	IP65
Height	65.5 mm
Width	70 mm

Certificates/approvals

General Product Approval	EMC	Declaration of Conformity	other
--------------------------	-----	---------------------------	-------



[Confirmation](#)

Further information

Information- and Downloadcenter (Catalogs, Brochures,...)

<http://www.siemens.com/industrial-controls/catalogs>

Industry Mall (Online ordering system)

<https://mall.industry.siemens.com/mall/en/en/Catalog/product?mfb=8WD4420-0CF>

Cax online generator

<http://support.automation.siemens.com/WW/CAXorder/default.aspx?lang=en&mfb=8WD4420-0CF>

Service&Support (Manuals, Certificates, Characteristics, FAQs,...)

<https://support.industry.siemens.com/cs/ww/en/ps/8WD4420-0CF>

Image database (product images, 2D dimension drawings, 3D models, device circuit diagrams, EPLAN macros, ...)

http://www.automation.siemens.com/bilddb/cax_de.aspx?mfb=8WD4420-0CF&lang=en

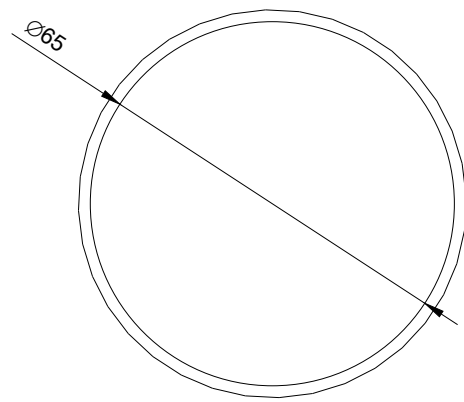
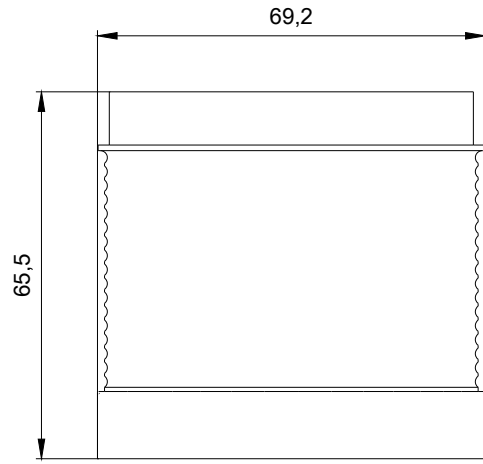

last modified:



WS 4444;
 W6.8333; 8WD44..._ALL
 01/16/2018