

COORDINATE SWITCH, 22MM, ROUND, METAL, SHINY, BLACK, 2 SWITCH POSITIONS, VERTICAL, LATCHING, WITHOUT MECH. INTERLOCK





Figure similar

|                          |                     |
|--------------------------|---------------------|
| Product brand name       | SIRIUS ACT          |
| Product designation      | Coordinate switches |
| Product type designation | 3SU1                |

| Actuator                                    |                              |
|---|------------------------------|
| Design of the operating mechanism           | without mechanical interlock |
| Manner of function of the actuating element | Latching                     |
| Direction of actuation                      | Vertical                     |
| Color                                       |                              |
| • of the actuating element                  | black                        |
| Material of the actuating element           | plastic                      |
| Shape of the actuating element              | Extended handle              |
| Outer diameter of the actuating element     | 30.5 mm                      |
| Type of unlocking device                    | without                      |
| Number of switching positions               | 2                            |

| Front ring                   |      |
|------------------------------|------|
| Product component front ring | Yes  |
| Design of the front ring     | high |

|   |   |
|---|---|
| <b>Material of the front ring</b>                         | Metal, high gloss   |
| <b>Color of the front ring</b>                            | silver  |
| <b>General technical data</b>                             |   |
| <b>Protection class IP</b>                                | IP65, IP67  |
| <b>Shock resistance</b>                                   | Sinusoidal half-wave 50 g / 11 ms                                   |
| • acc. to IEC 60068-2-27                                  |   |
| <b>Vibration resistance</b>                               | 10 ... 500 Hz: 5g   |
| • acc. to IEC 60068-2-6                                   |   |
| <b>Operating frequency maximum</b>                        | 3 600 1/h   |
| <b>Mechanical service life (switching cycles)</b>         | 250 000   |
| • as operating period per direction of actuation typical  |   |
| <b>Equipment marking</b>                                  | S   |
| • acc. to DIN EN 61346-2                                  |   |
| • acc. to DIN EN 81346-2                                  | S   |
| <b>Auxiliary circuit</b>                                  |   |
| <b>Number of NC contacts</b>                              | 0   |
| • for auxiliary contacts                                  |   |
| <b>Number of NO contacts</b>                              | 0   |
| • for auxiliary contacts                                  |   |
| <b>Number of CO contacts</b>                              | 0   |
| • for auxiliary contacts                                  |   |
| <b>Ambient conditions</b>                                 |   |
| <b>Ambient temperature</b>                                | -25 ... +70 °C  |
| • during operation  |   |
| • during storage  | -40 ... +80 °C  |
| Environmental category during operation acc. to IEC 60721 | 3M6, 3S2, 3B2, 3C3, 3K6 (with relative air humidity of 10 ... 95 %) |
| <b>Installation/ mounting/ dimensions</b>                 |   |
| <b>Height</b>   | 30.5 mm   |
| <b>Width</b>  | 30.5 mm   |
| <b>Shape of the installation opening</b>                  | round   |
| <b>Mounting diameter</b>                                  | 22.3 mm   |
| <b>Positive tolerance of installation diameter</b>        | 0.4 mm  |
| <b>Mounting height</b>                                    | 71.3 mm   |
| <b>Installation width</b>                                 | 30.5 mm   |
| <b>Installation depth</b>                                 | 25.6 mm   |
| <b>Certificates/approvals</b>                             |   |

| General Product Approval   |   |   | Declaration of Conformity   | Test Certificates  |  |
|--|---|---|---|--|--|
| <br>CSA | <br>UL |  | <br>EG-Konf. | <a href="#">Declaration of the Compliance with the order</a> | <a href="#">Special Test Certificate</a> |

**other**

[Confirmation](#)

**Further information**

**Information- and Downloadcenter (Catalogs, Brochures,...)**

<http://www.siemens.com/industrial-controls/catalogs>

**Industry Mall (Online ordering system)**

<https://mall.industry.siemens.com/mall/en/en/Catalog/product?mlfb=3SU1050-7AB88-0AA0>

**Cax online generator**

<http://support.automation.siemens.com/WW/CAXorder/default.aspx?lang=en&mlfb=3SU1050-7AB88-0AA0>

**Service&Support (Manuals, Certificates, Characteristics, FAQs,...)**

<https://support.industry.siemens.com/cs/ww/en/ps/3SU1050-7AB88-0AA0>

**Image database (product images, 2D dimension drawings, 3D models, device circuit diagrams, EPLAN macros, ...)**

[http://www.automation.siemens.com/bilddb/cax\\_de.aspx?mlfb=3SU1050-7AB88-0AA0&lang=en](http://www.automation.siemens.com/bilddb/cax_de.aspx?mlfb=3SU1050-7AB88-0AA0&lang=en)

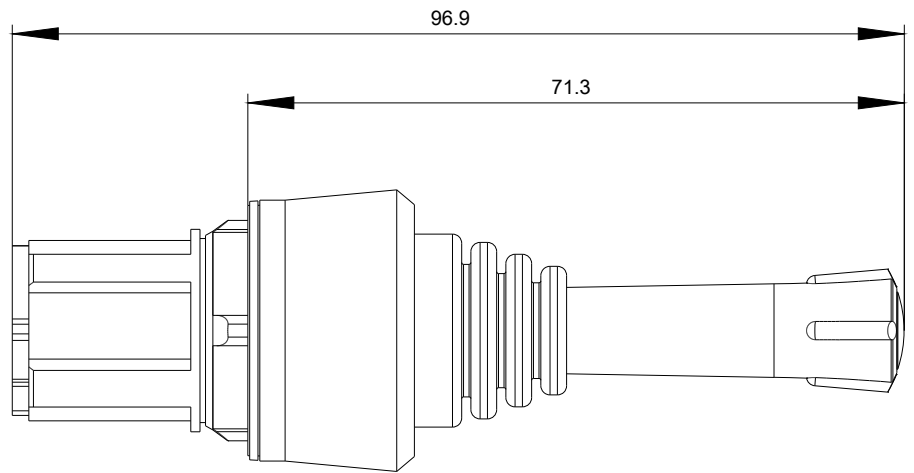

last modified:

09/25/2017