

SURGE SUPPRESSOR, SUPPRESSION DIODE DC  
12...250V, F. CONT. RELAYS A. MOTOR CONT. SZ  
S00, MULTI-UNIT PACKAGING



General technical data:

product brandname		SIRIUS
Product designation		surge suppressor
Size of contactor		S00
Design of the surge suppressor		with diode
Ambient temperature		
• during storage	°C	-40 ... +80
• during operation	°C	-25 ... +60

Control circuit/ Control:

Type of voltage of the control supply voltage		DC
Control supply voltage 1		
• at DC		
— Initial rated value	V	12
— Final rated value	V	250





Installation/ mounting/ dimensions:

Mounting position		any
Mounting type		clip-on
Width	mm	28

Height	mm	46
Depth	mm	9

#### Certificates/ approvals:

Certificate of suitability CE / UL / CSA / CCC

General Product Approval	Declaration of Conformity	Test Certificates		Shipping Approval
 CSA		 EG-Konf.	<a href="#">Special Test Certificate</a>	<a href="#">Type Test Certificates/Test Report</a>  ABS

#### Shipping Approval



#### other

[Environmental Confirmations](#)

[Confirmation](#)



#### Further information

**Information- and Downloadcenter (Catalogs, Brochures,...)**

<http://www.siemens.com/industrial-controls/catalogs>

**Industry Mall (Online ordering system)**

<http://www.siemens.com/industrymall>

**Cax online generator**

<http://support.automation.siemens.com/WW/CAXorder/default.aspx?lang=en&mlfb=3RT2916-1DG00-Z X90>

**Service&Support (Manuals, Certificates, Characteristics, FAQs,...)**

<https://support.industry.siemens.com/cs/ww/en/ps/3RT2916-1DG00-Z X90>

**Image database (product images, 2D dimension drawings, 3D models, device circuit diagrams, EPLAN macros, ...)**

[http://www.automation.siemens.com/bilddb/cax\\_de.aspx?mlfb=3RT2916-1DG00-Z X90&lang=en](http://www.automation.siemens.com/bilddb/cax_de.aspx?mlfb=3RT2916-1DG00-Z X90&lang=en)

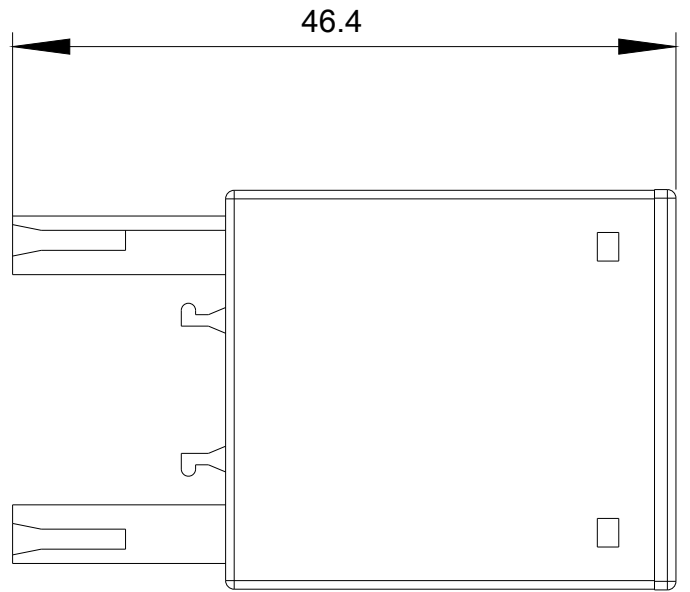
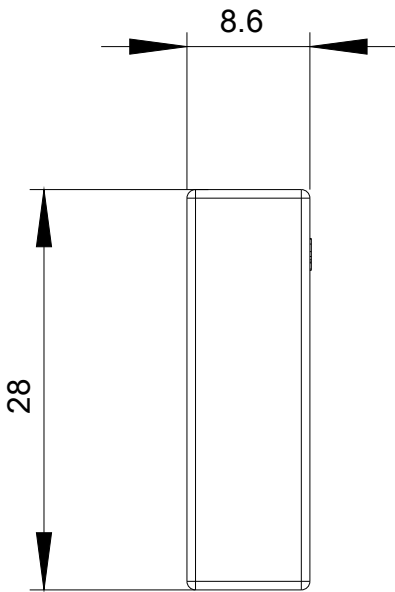

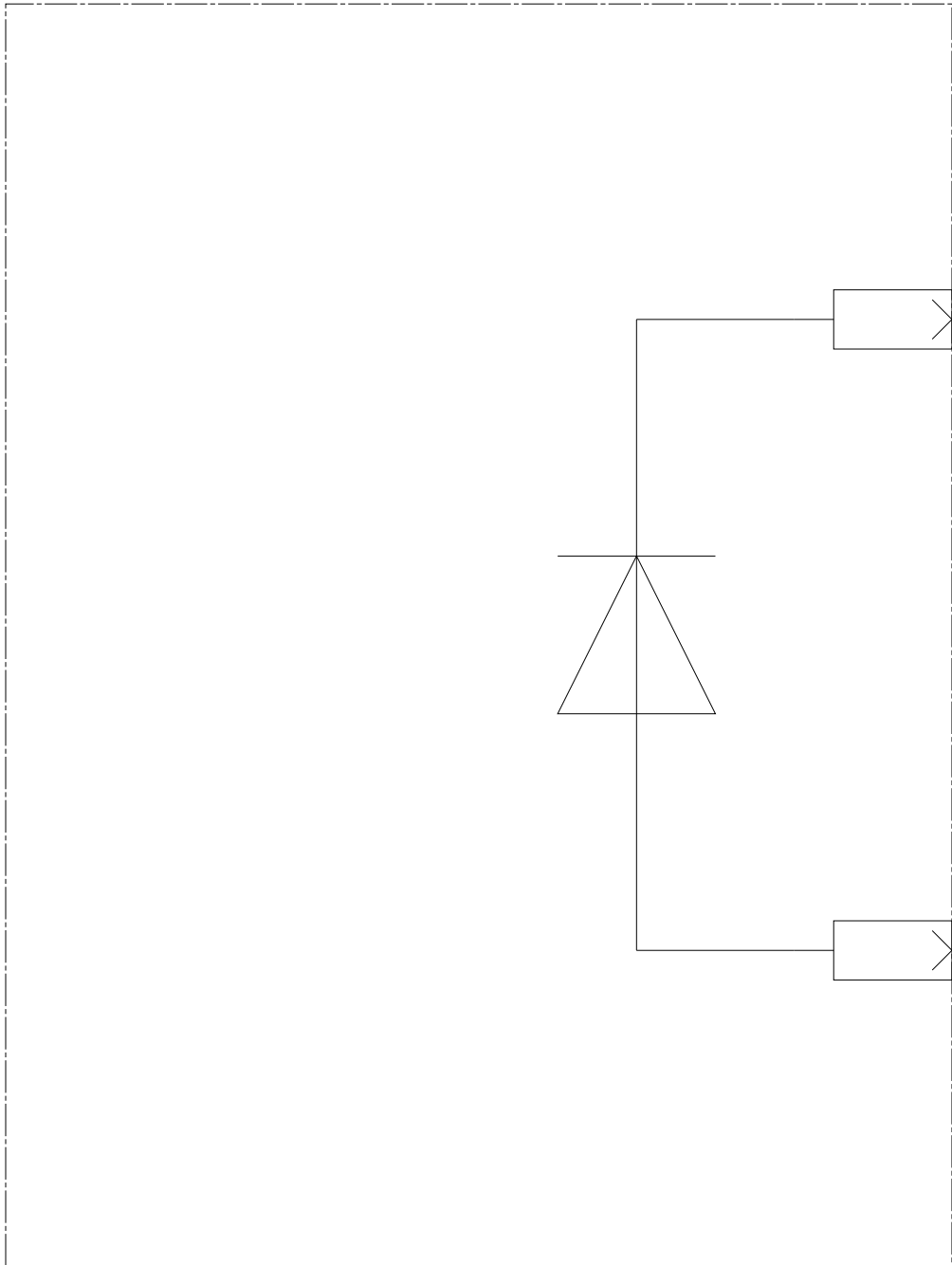

last modified:

06/20/2017